

TA三菱舍弃式快速钻头

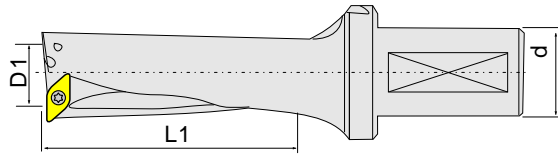

注：此系列U钻加工不锈钢效果最理想。

型号	Model	Insert 刀片	parts	(d) 接口	D1	D × 2倍				D × 3倍				D × 4倍									
						Order	型号	L1	Price	Order	型号	L1	Price	Order	型号	L1	Price						
TAF		GCMT 040204-U...	M2.0 T6	(20) PT	1/8	12	.5056	12	F2290	1.10	5.56	3M12.00	F4210	1.32	5.56	10.12.00	F5250	1.58	4.4				
TAF						12	.5556	12	F2290	1.10	5.56	3M12.25	F4210	1.32	5.56	10.12.25	F5250	1.58	4.4				
TAF						13	.5056	13	F3210	1.10	5.56	3M13.00	F4240	1.32	5.56	10.13.00	F6200	1.58	4.4				
TAF						13	.5556	13	F3210	1.10	5.56	3M13.50	F4240	1.32	5.56	10.13.50	F6200	1.58	4.4				
TAF						14	.5056	14	F3230	1.10	5.56	3M14.00	F4270	1.32	5.56	10.14.00	F6200	1.58	4.4				
TAF						14	.5556	14	F3230	1.10	5.56	3M14.50	F4270	1.32	5.56	10.14.50	F6200	1.58	4.4				
TAF						GPMT 060204-U...	M2.5 T6	(20) PT	1/8	15	.5056	15	F3250	1.10	5.56	3M15.00	F4270	1.32	5.56	10.15.00	F7200	1.29	6
TAF										15	.5556	15	F3250	1.10	5.56	3M15.50	F4270	1.32	5.56	10.15.50	F7200	1.29	6
TAF										16	.5056	16	F3285	1.10	5.56	3M16.00	F4245	1.08	5.56	10.16.00	F7255	1.29	6
TAF										16	.5556	16	F3285	1.10	5.56	3M16.50	F4245	1.08	5.56	10.16.50	F7255	1.29	6
TAF										17	.5056	17	F4215	1.10	5.56	3M17.00	F4285	1.08	5.56	10.17.00	F7255	1.29	6
TAF										17	.5556	17	F4215	1.10	5.56	3M17.50	F4285	1.08	5.56	10.17.50	F7255	1.29	6
TAF		GPMT 070204-U...	M3.0 T6	(20) PT	1/8	18	.5056	18	F4235	1.10	5.56	3M18.00	F4215	1.08	5.56	10.18.00	F7295	1.29	6				
TAF						18	.5556	18	F4235	1.10	5.56	3M18.50	F4215	1.08	5.56	10.18.50	F7295	1.29	6				
TAF						19	.5056	19	F4265	1.10	5.56	3M19.00	F4215	1.08	5.56	10.19.00	F8245	1.29	6				
TAF						19	.5556	19	F4265	1.10	5.56	3M19.50	F4215	1.08	5.56	10.19.50	F8245	1.29	6				
TAF						20	.5056	20	F4285	1.10	5.56	3M20.00	F4215	1.08	5.56	10.20.00	F8285	1.29	6				
TAF						20	.5556	20	F4285	1.10	5.56	3M20.50	F4215	1.08	5.56	10.20.50	F8285	1.29	6				
TAF						GPMT 090304-U...	M3.0 T6	(20) PT	1/8	21	.5056	21	F5205	1.00	5.56	3M21.00	F7215	1.20	5.56	10.21.00	F9225	1.44	0
TAF										21	.5556	21	F5205	1.00	5.56	3M21.50	F7215	1.20	5.56	10.21.50	F9225	1.44	0
TAF										22	.5056	22	F5235	1.00	5.56	3M22.00	F7215	1.20	5.56	10.22.00	F9275	1.44	0
TAF										22	.5556	22	F5235	1.00	5.56	3M22.50	F7215	1.20	5.56	10.22.50	F9275	1.44	0
TAF										23	.5056	23	F5255	1.00	5.56	3M23.00	F7215	1.20	5.56	10.23.00	F12051	1.44	0
TAF										23	.5556	23	F5255	1.00	5.56	3M23.50	F7215	1.20	5.56	10.23.50	F12051	1.44	0
TAF		GPMT 11T308-U...	M4.0 T6	(30) PT	1/8	24	.5056	24	F5285	1.00	5.56	3M24.00	F8225	1.20	5.56	10.24.00	F12055	1.44	0				
TAF						24	.5556	24	F5285	1.00	5.56	3M24.50	F8225	1.20	5.56	10.24.50	F12055	1.44	0				
TAF						25	.5056	25	F6302	1.00	5.56	3M25.00	F8852	1.20	5.56	10.25.00	F13120	1.44	0				
TAF						25	.5556	25	F6302	1.00	5.56	3M25.50	F8852	1.20	5.56	10.25.50	F13120	1.44	0				
TAF						26	.5056	26	F6322	1.20	5.56	3M26.00	F8882	1.44	5.56	10.26.00	F13124	1.72	8				
TAF						26	.5556	26	F6322	1.20	5.56	3M26.50	F8882	1.44	5.56	10.26.50	F13124	1.72	8				
TAF						GPMT 140408-U...	M5.5 T6	(40) PT	1/8	27	.5056	27	F6352	1.20	5.56	3M27.00	F9822	1.44	5.56	10.27.00	F14032	1.72	8
TAF										27	.5556	27	F6352	1.20	5.56	3M27.50	F9822	1.44	5.56	10.27.50	F14032	1.72	8
TAF										28	.5056	28	F6372	1.20	5.56	3M28.00	F9852	1.44	5.56	10.28.00	F14032	1.72	8
TAF										28	.5556	28	F6372	1.20	5.56	3M28.50	F9852	1.44	5.56	10.28.50	F14032	1.72	8
TAF										29	.5056	29	F7302	1.20	5.56	3M29.00	F9892	1.44	5.56	10.29.00	F14032	1.72	8
TAF										29	.5556	29	F7302	1.20	5.56	3M29.50	F9892	1.44	5.56	10.29.50	F14032	1.72	8
TAF		GPMT 090304-U...	M3.0 T6	(30) PT	1/8	30	.5056	30	F8420	1.20	5.56	3M30.00	F14002	1.44	5.56	10.30.00	F14002	1.72	8				
TAF						31	.5056	31	F7440	1.30	5.56	3M31.00	F14005	1.56	5.56	10.31.00	F14005	1.87	2				
TAF						32	.5056	32	F7470	1.30	5.56	3M32.00	F14009	1.56	5.56	10.32.00	F14009	1.87	2				
TAF						33	.5056	33	F7490	1.30	5.56	3M33.00	F14102	1.56	5.56	10.33.00	F14005	1.87	2				
TAF						34	.5056	34	F8420	1.30	5.56	3M34.00	F14106	1.56	5.56	10.34.00	F14009	1.87	2				
TAF						35	.5056	35	F8440	1.30	5.56	3M35.00	F14109	1.56	5.56	10.35.00	F14009	1.87	2				
TAF						GPMT 140408-U...	M5.5 T6	(40) PT	1/8	36	.5056	36	F8460	1.50	5.56	3M36.00	F14202	1.80	5.56	10.36.00	F14004	2.16	0
TAF										37	.5056	37	F8490	1.50	5.56	3M37.00	F14206	1.80	5.56	10.37.00	F14006	2.16	0
TAF										38	.5056	38	F9410	1.50	5.56	3M38.00	F14209	1.80	5.56	10.38.00	F14006	2.16	0
TAF										39	.5056	39	F9440	1.50	5.56	3M39.00	F14303	1.80	5.56	10.39.00	F14006	2.16	0
TAF										40	.5056	40	F9460	1.50	5.56	3M40.00	F14306	1.80	5.56	10.40.00	F14006	2.16	0
TAF										41	.5056	41	F9480	1.80	5.56	3M41.00	F14309	2.16	5.56	10.41.00	F14004	2.59	2
TAF		GPMT 090304-U...	M3.0 T6	(30) PT	1/8	42	.5056	42	F1400	1.80	5.56	3M42.00	F14403	2.16	5.56	10.42.00	F14006	2.59	2				
TAF						43	.5056	43	F1400	1.80	5.56	3M43.00	F14406	2.16	5.56	10.43.00	F14006	2.59	2				
TAF						44	.5056	44	F1400	1.80	5.56	3M44.00	F14500	2.16	5.56	10.44.00	F14006	2.59	2				
TAF						45	.5056	45	F1400	1.80	5.56	3M45.00	F14503	2.16	5.56	10.45.00	F14006	2.59	2				
TAF						46	.5056	46	F1400	2.00	5.56	3M46.00	F14506	2.40	5.56	10.46.00	F14006	2.88	0				
TAF						47	.5056	47	F1400	2.00	5.56	3M47.00	F14600	2.40	5.56	10.47.00	F14006	2.88	0				
TAF		GPMT 090304-U...	M3.0 T6	(30) PT	1/8	48	.5056	48	F1400	2.00	5.56	3M48.00	F14603	2.40	5.56	10.48.00	F2402	2.88	0				
TAF						49	.5056	49	F1400	2.00	5.56	3M49.00	F14607	2.40	5.56	10.49.00	F2406	2.88	0				
TAF						50	.5056	50	F1400	2.00	5.56	3M50.00	F14700	2.40	5.56	10.50.00	F2400	2.88	0				
TAF						51	.5056	51	F1400	2.50	5.56	3M51.00	F14703	3.00	5.56	10.51.00	F2404	3.60	0				
TAF						52	.5056	52	F1400	2.50	5.56	3M52.00	F14707	3.00	5.56	10.52.00	F2400	3.60	0				
TAF						53	.5056	53	F1400	2.50	5.56	3M53.00	F14800	3.00	5.56	10.53.00	F2402	3.60	0				
TAF						54	.5056	54	F1400	2.50	5.56	3M54.00	F14802	3.00	5.56	10.54.00	F2406	3.60	0				
TAF						55	.5056	55	F1400	3.00	5.56	3M55.00	F14805	3.60	5.56	10.55.00	F2400	4.32	0				
TAF						56	.5056	56	F1400	3.00	5.56	3M56.00	F14808	3.60	5.56	10.56.00	F2404	4.32	0				

快速
钻孔

镗孔
加工
系统

钻头

铰刀

快速
钻头

高精度
铰钻

VMD
大钻头

U钻
配件

BH
镗孔

RBH
粗镗

CBH
精镗

CBR
外圆
精镗

WBST
镗孔

CBI
小径
精镗

精镗
套装

镗孔
配件

BS
粗镗

高速
钢钻头

钨钢
钻头

铰刀

舍弃式钻头 | Abandon Type Drill

住友WD舍弃式快速钻头

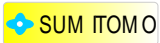

特固克快钻另询价

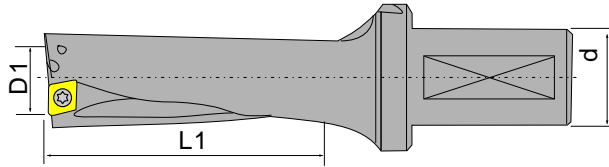

型号 Model	Insert 刀片	parts 刀片	d	D1	D × 2倍			D × 3倍			D × 4倍			D × 5倍		
					型号	L1	Price	型号	L1	Price	型号	L1	Price	型号	L1	Price
WD X1 3 0	WDX T 0 4 2 0	M 1 . 6 x 4 0 4 T 6	2 0	1 3 .	∅ 2 S 2 0 2 9	4 0 6	6 D 3 S 2 0 4 2	0 2 7	5 D 4 S 2 0 5 5	4 9 2	0 D 5 S 2 0 6 8	0 3 5	2			
WD X1 3 5				1 3 .	∅ 2 S 2 0 3 0	4 0 6	6 D 3 S 2 0 4 3	0 2 7	5 D 4 S 2 0 5 7	4 9 2	0 D 5 S 2 0 7 0	0 3 5	2			
WD X1 4 0				1 4 .	∅ 2 S 2 0 3 1	4 0 6	6 D 3 S 2 0 4 5	0 2 7	5 D 4 S 2 0 5 9	4 9 2	0 D 5 S 2 0 7 3	0 3 5	2			
WD X1 4 5				1 4 .	∅ 2 S 2 0 3 2	4 0 6	6 D 3 S 2 0 4 6	0 2 7	5 D 4 S 2 0 6 1	4 9 2	0 D 5 S 2 0 7 5	0 3 5	2			
WD X1 5 0	WDX T 0 5 2 5	M 2 . 0 x 4 0 4 T 6	2 0	1 5 .	∅ 2 S 2 0 3 3	4 0 6	6 D 3 S 2 0 4 8	0 2 7	5 D 4 S 2 0 6 3	4 9 2	0 D 5 S 2 0 7 8	0 3 5	2			
WD X1 5 5				1 5 .	∅ 2 S 2 0 3 4	4 1 6	0 D 3 S 2 0 4 9	0 3 7	9 D 4 S 2 0 6 5	5 0 3	9 D 5 S 2 0 8 0	0 4 7	1			
WD X1 6 0				1 6 .	∅ 2 S 2 0 3 5	4 1 6	0 D 3 S 2 0 5 1	0 3 7	9 D 4 S 2 0 6 7	5 0 3	9 D 5 S 2 0 8 3	0 4 7	1			
WD X1 6 5				1 6 .	∅ 2 S 2 0 3 6	4 1 6	0 D 3 S 2 0 5 2	0 3 7	9 D 4 S 2 0 6 9	5 0 3	9 D 5 S 2 0 8 5	0 4 7	1			
WD X1 7 0	WDX T 0 6 3 0	M 2 . 2 x 6 0 6 T 7	2 5	1 7 .	∅ 2 S 2 0 3 7	4 1 6	0 D 3 S 2 0 5 4	0 3 7	9 D 4 S 2 0 7 1	5 0 3	9 D 5 S 2 0 8 8	0 4 7	1			
WD X1 7 5				1 7 .	∅ 2 S 2 0 3 8	4 3 6	1 D 3 S 2 0 5 5	0 5 8	8 D 4 S 2 0 5 7	5 2 7	8 D 5 S 2 0 5 9	0 7 3	6			
WD X1 8 0				1 8 .	∅ 2 S 2 0 3 9	4 3 6	1 D 3 S 2 0 5 7	0 5 8	8 D 4 S 2 0 5 9	5 2 7	8 D 5 S 2 0 6 1	0 7 3	6			
WD X1 8 5				1 8 .	∅ 2 S 2 0 4 0	4 4 6	1 D 3 S 2 0 5 8	0 6 8	9 D 4 S 2 0 6 1	5 3 9	7 D 5 S 2 0 6 3	0 5 9	7			
WD X1 9 0	WDX T 0 7 3 5	M 2 . 5 x 6 0 6 T 8	3 2	1 9 .	∅ 2 S 2 0 4 1	4 4 6	1 D 3 S 2 0 6 0	0 6 8	9 D 4 S 2 0 6 3	5 3 9	7 D 5 S 2 0 6 5	0 5 9	7			
WD X1 9 5				1 9 .	∅ 2 S 2 0 4 2	4 4 6	1 D 3 S 2 0 6 1	0 6 8	9 D 4 S 2 0 6 4	5 3 9	7 D 5 S 2 0 6 6	0 5 9	7			
WD X2 0 0				2 0 .	∅ 2 S 2 0 4 3	4 4 6	1 D 3 S 2 0 6 3	0 6 8	9 D 4 S 2 0 6 5	5 3 9	7 D 5 S 2 0 6 7	0 5 9	7			
WD X2 0 5				2 0 .	∅ 2 S 2 0 4 4	4 4 6	1 D 3 S 2 0 6 4	0 6 8	9 D 4 S 2 0 6 6	5 3 9	7 D 5 S 2 0 6 8	0 5 9	7			
WD X2 1 0	WDX T 0 9 4 0	M 3 . 5 x 8 0 8 T 1 5	4 0	2 1 .	∅ 2 S 2 0 4 5	4 4 6	1 D 3 S 2 0 6 6	0 6 8	9 D 4 S 2 0 6 8	5 3 9	7 D 5 S 2 0 7 0	0 5 9	7			
WD X2 1 5				2 1 .	∅ 2 S 2 0 4 6	4 4 6	1 D 3 S 2 0 6 7	0 6 8	9 D 4 S 2 0 6 9	5 3 9	7 D 5 S 2 0 7 1	0 5 9	7			
WD X2 2 0				2 2 .	∅ 2 S 2 0 4 7	4 4 6	1 D 3 S 2 0 6 9	0 6 8	9 D 4 S 2 0 7 1	5 3 9	7 D 5 S 2 0 7 3	0 5 9	7			
WD X2 2 5				2 2 .	∅ 2 S 2 0 4 8	4 4 6	1 D 3 S 2 0 7 0	0 6 8	9 D 4 S 2 0 7 3	5 3 9	7 D 5 S 2 0 7 5	0 5 9	7			
WD X2 3 0	WDX T 1 2 5 0	M 5 . 0 x 1 2 1 2 T 1 5	1 5	2 3 .	∅ 2 S 2 0 4 9	4 5 5	8 D 3 S 2 0 7 2	0 7 9	7 D 4 S 2 0 7 5	5 5 1	2 D 5 S 2 0 8 1	0 5 9	3			
WD X2 3 5				2 3 .	∅ 2 S 2 0 5 0	4 5 5	8 D 3 S 2 0 7 3	0 7 9	7 D 4 S 2 0 7 7	5 5 1	2 D 5 S 2 0 8 3	0 5 9	3			
WD X2 4 0				2 4 .	∅ 2 S 2 0 5 1	4 5 5	8 D 3 S 2 0 7 5	0 7 9	7 D 4 S 2 0 7 9	5 5 1	2 D 5 S 2 0 8 5	0 5 9	3			
WD X2 4 5				2 4 .	∅ 2 S 2 0 5 2	4 5 5	8 D 3 S 2 0 7 6	0 7 9	7 D 4 S 2 0 8 1	5 5 1	2 D 5 S 2 0 8 7	0 5 9	3			
WD X2 5 0	WDX T 1 5 6 0	M 6 . 0 x 1 5 1 2 T 1 5	1 5	2 5 .	∅ 2 S 2 0 5 3	4 5 5	8 D 3 S 2 0 7 8	0 7 9	7 D 4 S 2 0 8 3	5 5 1	2 D 5 S 2 0 8 9	0 5 9	3			
WD X2 5 5				2 5 .	∅ 2 S 3 0 2 5	4 7 5	2 D 3 S 3 0 2 7	5 0 0	2 D 4 S 3 0 2 1	5 7 5	5 D 5 S 3 0 2 2	-	-			
WD X2 6 0				2 6 .	∅ 2 S 3 0 2 5	4 7 5	2 D 3 S 3 0 2 8	0 0 0	2 D 4 S 3 0 2 1	5 7 5	5 D 5 S 3 0 2 3	3 6 2	5 4			
WD X2 6 5				2 6 .	∅ 2 S 3 0 2 6	4 7 5	2 D 3 S 3 0 2 8	5 0 0	2 D 4 S 3 0 2 1	5 7 5	5 D 5 S 3 0 2 3	3 6 2	5 4			
WD X2 7 0	WDX T 1 8 6 0	M 6 . 0 x 1 5 1 2 T 1 5	1 5	2 7 .	∅ 2 S 3 0 2 7	4 7 5	2 D 3 S 3 0 2 8	5 0 0	2 D 4 S 3 0 2 1	5 7 5	5 D 5 S 3 0 2 4	3 6 2	5 4			
WD X2 7 5				2 7 .	∅ 2 S 3 0 2 8	4 7 5	2 D 3 S 3 0 2 8	5 0 0	2 D 4 S 3 0 2 1	5 7 5	5 D 5 S 3 0 2 4	3 6 2	5 4			
WD X2 8 0				2 8 .	∅ 2 S 3 0 2 9	4 7 5	2 D 3 S 3 0 2 8	0 0 0	2 D 4 S 3 0 2 1	5 7 5	5 D 5 S 3 0 2 4	3 6 2	5 4			
WD X2 8 5				2 8 .	∅ 2 S 3 0 2 0	4 7 5	2 D 3 S 3 0 2 8	5 0 0	2 D 4 S 3 0 2 1	5 7 5	5 D 5 S 3 0 2 4	3 6 2	5 4			
WD X2 9 0	WDX T 1 8 6 0	M 6 . 0 x 1 5 1 2 T 1 5	1 5	2 9 .	∅ 2 S 3 0 2 2	4 7 5	2 D 3 S 3 0 2 9	0 0 0	2 D 4 S 3 0 2 2	5 7 5	5 D 5 S 3 0 2 4	3 6 2	5 4			
WD X2 9 5				2 9 .	∅ 2 S 3 0 2 3	4 7 5	2 D 3 S 3 0 2 9	5 0 0	2 D 4 S 3 0 2 2	5 7 5	5 D 5 S 3 0 2 4	3 6 2	5 4			
WD X3 0 0				3 0 .	∅ 2 S 3 0 2 4	-	D 3 S 3 0 2 9	0 -	D 4 S 3 0 2 2	6 4 0	0 D 5 S 3 0 2 5	4 6 7	6			
WD X3 1 0				3 1 .	∅ 2 S 3 0 2 6	-	D 3 S 3 0 2 9	0 -	D 4 S 3 0 2 2	6 4 0	0 D 5 S 3 0 2 5	4 6 7	6			
WD X3 2 0	WDX T 1 8 6 0	M 6 . 0 x 1 5 1 2 T 1 5	1 5	3 2 .	∅ 2 S 3 0 2 8	-	D 3 S 3 0 2 1	0 -	D 4 S 3 0 2 3	6 4 0	0 D 5 S 3 0 2 6	4 6 7	6			
WD X3 3 0				3 0 .	∅ 2 S 4 0 0 6	5 1 4	7 D 3 S 4 0 0 9	0 4 2	3 D 4 S 4 0 1 2	6 2 5	0 D 5 S 4 0 1 5	4 6 7	6			
WD X3 3 5				3 1 .	∅ 2 S 4 0 0 6	5 1 4	7 D 3 S 4 0 0 9	0 4 2	3 D 4 S 4 0 1 2	6 2 5	0 D 5 S 4 0 1 5	4 6 7	6			
WD X3 4 0				3 2 .	∅ 2 S 4 0 0 8	5 1 4	7 D 3 S 4 0 0 1	0 4 2	3 D 4 S 4 0 1 3	6 2 5	0 D 5 S 4 0 1 6	4 6 7	6			
WD X3 4 5	WDX T 1 8 6 0	M 6 . 0 x 1 5 1 2 T 1 5	1 5	3 3 .	∅ 2 S 4 0 0 7	5 1 4	7 D 3 S 4 0 0 1	0 4 2	3 D 4 S 4 0 1 3	6 2 5	0 D 5 S 4 0 1 6	4 6 7	6			
WD X3 5 0				3 4 .	∅ 2 S 4 0 0 7	5 1 4	7 D 3 S 4 0 0 1	0 4 2	3 D 4 S 4 0 1 3	6 2 5	0 D 5 S 4 0 1 7	4 6 7	6			
WD X3 6 0				3 5 .	∅ 2 S 4 0 0 7	5 1 4	7 D 3 S 4 0 0 1	0 4 2	3 D 4 S 4 0 1 3	6 2 5	0 D 5 S 4 0 1 7	4 6 7	6			
WD X3 7 0				3 6 .	∅ 2 S 4 0 0 7	5 1 4	7 D 3 S 4 0 0 1	0 4 2	3 D 4 S 4 0 1 3	6 2 5	0 D 5 S 4 0 1 8	4 6 7	6			
WD X3 8 0	WDX T 1 8 6 0	M 6 . 0 x 1 5 1 2 T 1 5	1 5	3 7 .	∅ 2 S 4 0 0 9	5 9 4	1 D 3 S 4 0 1 1	6 2 5	4 D 4 S 4 0 1 5	7 1 9	0 D 5 S 4 0 1 9	0	0			
WD X3 9 0				3 8 .	∅ 2 S 4 0 0 8	5 9 4	1 D 3 S 4 0 1 1	6 2 5	4 D 4 S 4 0 1 5	7 1 9	0 D 5 S 4 0 1 9	5	0			
WD X4 0 0				3 9 .	∅ 2 S 4 0 0 8	5 9 4	1 D 3 S 4 0 1 2	6 2 5	4 D 4 S 4 0 1 6	7 1 9	0 D 5 S 4 0 2 0	0	0			
WD X4 1 0				4 0 .	∅ 2 S 4 0 0 5	5 9 4	1 D 3 S 4 0 1 2	6 2 5	4 D 4 S 4 0 1 6	7 1 9	0 D 5 S 4 0 2 0	5	0			
WD X4 2 0	WDX T 1 8 6 0	M 6 . 0 x 1 5 1 2 T 1 5	1 5	4 1 .	∅ 2 S 4 0 0 7	5 9 4	1 D 3 S 4 0 1 2	6 2 5	4 D 4 S 4 0 1 6	7 1 9	0 D 5 S 4 0 2 1	1 0	0			
WD X4 3 0				4 2 .	∅ 2 S 4 0 0 9	5 9 4	1 D 3 S 4 0 1 3	6 2 5	4 D 4 S 4 0 1 7	7 1 9	0 D 5 S 4 0 2 2	0	0			
WD X4 4 0				4 3 .	∅ 2 S 4 0 0 9	5 9 4	1 D 3 S 4 0 1 3	6 2 5	4 D 4 S 4 0 1 7	7 1 9	0 D 5 S 4 0 2 2	0	0			
WD X4 5 0				4 4 .	∅ 2 S 4 0 0 9	5 9 4	1 D 3 S 4 0 1 3	6 2 5	4 D 4 S 4 0 1 7	7 1 9	0 D 5 S 4 0 2 2	5	0			
WD X4 6 0	WDX T 1 8 6 0	M 6 . 0 x 1 5 1 2 T 1 5	1 5	4 5 .	∅ 2 S 4 0 0 9	5 9 4	1 D 3 S 4 0 1 4	6 2 5	4 D 4 S 4 0 1 8	7 1 9	0 D 5 S 4 0 2 3	0	0			
WD X4 7 0				4 6 .	∅ 2 S 4 0 0 9	6 4 4	4 D 3 S 4 0 1 4	6 7 7	6 D 4 S 4 0 1 8	7 7 9	7 D 5 S 4 0 2 3	5	0			
WD X4 8 0				4 7 .	∅ 2 S 4 0 0 9	6 4 4	4 D 3 S 4 0 1 4	6 7 7	6 D 4 S 4 0 1 8	7 7 9	7 D 5 S 4 0 2 4	0	0			
WD X4 9 0				4 8 .	∅ 2 S 4 0 1 0	6 4 4	4 D 3 S 4 0 1 4	6 7 7	6 D 4 S 4 0 1 9	7 7 9	7 D 5 S 4 0 2 4	5	0			
WD X5 0 0	WDX T 1 8 6 0	M 6 . 0 x 1 5 1 2 T 1 5	1 5	4 9 .	∅ 2 S 4 0 1 0	6 4 4	4 D 3 S 4 0 1 5	6 7 7	6 D 4 S 4 0 2 0	7 7 9	7 D 5 S 4 0 2 5	0	0			
WD X5 1 0				5 0 .	∅ 2 S 4 0 1 0	6 4 4	4 D 3 S 4 0 1 5	6 7 7	6 D 4 S 4 0 2 0	7 7 9	7 D 5 S 4 0 2 5	5	0			
WD X5 2 0				5 1 .	∅ 2 S 4 0 1 0	6 7 6	5 D 3 S 4 0 1 5	7 1 1	5 D 4 S 4 0 2 0	8 1 9	2 D 5 S 4 0 2 6	0	0			
WD X5 3 0				5 2 .	∅ 2 S 4 0 1 0	6 7 6	5 D 3 S 4 0 1 6	7 1 1	5 D 4 S 4 0 2 1	8 1 9	2 D 5 S 4 0 2 6	5	0			
WD X5 4 0	WDX T 1 8 6 0	M 6 . 0 x 1 5 1 2 T 1 5	1 5	5 3 .	∅ 2 S 4 0 1 1	6 7 6	5 D 3 S 4 0 1 6	7 1 1	5 D 4 S 4 0 2 2	8 1 9	2 D 5 S 4 0 2 7	0	0			
WD X5 5 0				5 4 .	∅ 2 S 4 0 1 1	6 7 6	5 D 3 S 4 0 1 6	7 1 1	5 D 4 S 4 0 2 2	8 1 9	2 D 5 S 4 0 2 7	5	0			
WD X5 6 0				5 5 .	∅ 2 S 4 0 1 1	6 7 6	5 D 3 S 4 0 1 7	7 1 1	5 D 4 S 4 0 2 2	8 1 9	2 D 5 S 4 0 2 8	0	0			
WD X5 7 0				5 6 .	∅ 2 S 4 0 1 2	7 6 1	1 D 3 S 4 0 1 7	8 4 4	2 D 4 S 4 0 2 3	9 6 4	2 D 5 S 4 0 2 8	0	0			
WD X5 8 0	WDX T 1 8 6 0	M 6 . 0 x 1 5 1 2 T 1 5	1 5	5 7 .	∅ 2 S 4 0 1 2	7 6 1	1 D 3 S 4 0 1 7	8 4 4	2 D 4 S 4 0 2 3	9 6 4	2 D 5 S 4 0 2 8	0	0			
WD X5 9 0				5 8 .	∅ 2 S 4 0 1 2	7 6 1	1 D 3 S 4 0 1 8	8 4 4	2 D 4 S 4 0 2 4	9 6 4	2 D 5 S 4 0 2 9	0	0			
WD X6 0 0				5 9 .	∅ 2 S 4 0 1 2	7 6 1	1 D 3 S 4 0 1 8	8 4 4	2 D 4 S 4 0 2 4	9 6 4	2 D 5 S 4 0 2 9	0	0			
WD X6 1 0				6 0 .	∅ 2 S 4 0 1 3	7 9 2	4 D 3 S 4 0 1 9	8 8 0	7 D 4 S 4 0 2 5	1 0 1 1	1 D 5 S 4 0 2 9	0	0			
WD X6 2 0	WDX T 1 8 6 0	M 6 . 0 x 1 5 1 2 T 1 5	1 5	6 1 .	∅ 2 S 4 0 1 3	7 9 2	4 D 3 S 4 0 1 9	8 8 0	7 D 4 S 4 0 2 5	1 0 1 1	1 D 5 S 4 0 2 9	0	0			
WD X6 3 0				6 2 .	∅ 2 S 4 0 1 3	7 9 2	4 D 3 S 4 0 1 9	8 8 0	7 D 4 S 4 0 2 5	1 0 1 1	1 D 5 S 4 0 2 9	0	0			
WD X6 4 0				6 3 .	∅ 2 S 4 0 1 3	7 9 2	4 D 3 S 4 0 1 9	8 8 0	7 D 4 S 4 0 2 6	1 0 1 1	1 D 5 S 4 0 2 9	0	0			
WD X6 5 0				6 4 .	∅ 2 S 4 0 1 3	7 9 2	4 D 3 S 4 0 2 0	8 8 0	7 D 4 S 4 0 2 6	1 0 1 1	1 D 5 S 4 0 2 9	0	0			
WD X6 5 0	6 5 .	∅ 2 S 4 0 1 3	7 9 2	4 D 3 S 4 0 2 0	8 8 0	7 D 4 S 4 0 2 6	1 0 1 1	1 D 5 S 4 0 2 9	0	0						

快速
钻孔

镗孔
加工
系统

钻头

铰刀

快速
钻头

高精度
铰钻

VMD
大钻头

U钻
配件

BH
镗孔

RBH
粗镗

住友WC型舍弃式快速钻头

2倍快速钻头 -WC刀片

3倍快速钻头 -WC刀片

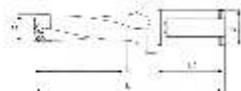

Order	型号 Model	L1	L2	L	D	d	适用刀片 Applicable to insert	螺丝 screw	扳手 Wrench	Price
503100	ZD02-14.0-XP25-WC03-02	33	56	106	14	25	WCMT030208	M2.5 x 6.5	T8	700
503102	ZD02-15.0-XP25-WC03-02	35	56	108	15					700
503104	ZD02-16.0-XP25-WC03-02	37	56	110	16					700
503106	ZD02-17.0-XP25-WC03-02	39	56	112	17					700
503108	ZD02-18.0-XP25-WC03-02	41	56	114	18					700
503110	ZD02-19.0-XP25-WC03-02	43	56	116	19					700
503112	ZD02-20.0-XP25-WC03-02	45	56	119	20					700
503114	ZD02-21.0-XP25-WC04-02	47	56	121	21					875
503116	ZD02-22.0-XP25-WC04-02	49	56	123	22					875
503118	ZD02-23.0-XP25-WC04-02	51	56	125	23					875
503120	ZD02-24.0-XP25-WC04-02	53	56	127	24					875
503122	ZD02-25.0-XP25-WC05-02	55	60	141	25					988
503124	ZD02-26.0-XP25-WC05-02	57	60	143	26					988
503126	ZD02-27.0-XP25-WC05-02	59	60	145	27					988
503128	ZD02-28.0-XP25-WC05-02	61	60	147	28	988				
503130	ZD02-29.0-XP25-WC05-02	63	60	149	29	988				
503132	ZD02-30.0-XP25-WC05-02	65	60	151	30	988				
503134	ZD02-31.0-XP25-WC05-02	67	60	153	31	1150				
503136	ZD02-32.0-XP25-WC06-02	69	60	155	32	1150				
503138	ZD02-33.0-XP25-WC06-02	71	60	157	33	1150				
503140	ZD02-34.0-XP25-WC06-02	73	60	159	34	1150				
503142	ZD02-35.0-XP25-WC06-02	75	60	161	35	1150				
503144	ZD02-36.0-XP25-WC06-02	77	60	163	36	1258				
503146	ZD02-37.0-XP25-WC06-02	79	60	165	37	1258				
503148	ZD02-38.0-XP25-WC06-02	81	60	167	38	1258				
503150	ZD02-39.0-XP25-WC06-02	83	60	169	39	1258				
503152	ZD02-40.0-XP25-WC06-02	85	60	171	40	1258				
503154	ZD02-41.0-XP25-WC06-02	87	60	173	41	1450				
503156	ZD02-42.0-XP25-WC06-02	89	60	175	42	1450				
503158	ZD02-43.0-XP40-WC08-02	91	65	186	43	1450				
503160	ZD02-44.0-XP40-WC08-02	93	65	188	44	1450				
503162	ZD02-45.0-XP40-WC08-02	95	65	190	45	1450				
503164	ZD02-46.0-XP40-WC08-02	97	65	192	46	1638				
503166	ZD02-47.0-XP40-WC08-02	99	65	194	47	1638				
503168	ZD02-48.0-XP40-WC08-02	101	65	196	48	1638				
503170	ZD02-49.0-XP40-WC08-02	103	65	198	49	1638				
503172	ZD02-50.0-XP40-WC08-02	105	65	200	50	1638				
503174	ZD02-51.0-XP40-WC08-02	107	65	202	51	1853				
503176	ZD02-52.0-XP40-WC08-02	109	65	204	52	1853				
503178	ZD02-53.0-XP40-WC08-02	111	65	206	53	1853				
503180	ZD02-54.0-XP40-WC08-02	113	65	208	54	1853				
503182	ZD02-55.0-XP40-WC08-02	115	65	210	55	1853				
503184	ZD02-56.0-XP40-WC08-02	117	65	212	56	2043				
503186	ZD02-57.0-XP40-WC08-02	119	65	214	57	2043				
503188	ZD02-58.0-XP40-WC08-02	121	65	216	58	2043				
503190	ZD02-59.0-XP40-WC08-02	123	65	218	59	2043				
503192	ZD02-60.0-XP40-WC08-02	125	65	220	60	2043				
503194	ZD02-61.0-XP40-WC08-02	127	65	222	61	2043				
503196	ZD02-62.0-XP40-WC08-02	129	65	224	62	2043				
503198	ZD02-63.0-XP40-WC08-02	131	65	226	63	2043				
503200	ZD02-64.0-XP40-WC08-02	133	65	228	64	2043				
503202	ZD02-65.0-XP40-WC08-02	135	65	230	65	2043				

Order	型号 Model	L1	L2	L	D	d	适用刀片 Applicable to insert	螺丝 screw	扳手 Wrench	Price
503300	ZD03-14.0-XP25-WC03-02	47	56	120	14	25	WCMT030208	M 2.5 x 6.5	T8	738
503302	ZD03-14.5-XP25-WC03-02	48.5	56	122	14.5					738
503304	ZD03-15.0-XP25-WC03-02	50	56	123	15					738
503306	ZD03-15.5-XP25-WC03-02	51.5	56	124	15.5					738
503308	ZD03-16.0-XP25-WC03-02	53	56	126	16					738
503310	ZD03-16.5-XP25-WC03-02	54.5	56	127	16.5					738
503312	ZD03-17.0-XP25-WC03-02	56	56	129	17					738
503314	ZD03-17.5-XP25-WC03-02	57.5	56	130	17.5					738
503316	ZD03-18.0-XP25-WC03-02	59	56	132	18					738
503318	ZD03-18.5-XP25-WC03-02	60.5	56	133	18.5					738
503320	ZD03-19.0-XP25-WC03-02	62	56	135	19					738
503322	ZD03-19.5-XP25-WC03-02	63.5	56	136	19.5					738
503324	ZD03-20.0-XP25-WC03-02	65	56	139	20					738
503326	ZD03-20.5-XP25-WC03-02	66.5	56	140	20.5					925
503328	ZD03-21.0-XP25-WC04-02	68	56	142	21	925				
503330	ZD03-21.5-XP25-WC04-02	69.5	56	143	21.5	925				
503332	ZD03-22.0-XP25-WC04-02	71	56	145	22	925				
503334	ZD03-22.5-XP25-WC04-02	72.5	56	148	22.5	925				
503336	ZD03-23.0-XP25-WC04-02	74	56	148	23	925				
503338	ZD03-23.5-XP25-WC04-02	75.5	56	149	23.5	925				
503340	ZD03-24.0-XP25-WC04-02	77	56	151	24	925				
503342	ZD03-24.5-XP25-WC04-02	78.5	56	152	24.5	925				
503344	ZD03-25.0-XP25-WC05-02	80	60	166	25	925				
503346	ZD03-25.5-XP25-WC05-02	81.5	60	167	25.5	1038				
503348	ZD03-26.0-XP25-WC05-02	83	60	169	26	1038				
503350	ZD03-26.5-XP25-WC05-02	84.5	60	170	26.5	1038				
503352	ZD03-27.0-XP25-WC05-02	86	60	172	27	1038				
503354	ZD03-27.5-XP25-WC05-02	87.5	60	173	27.5	1038				
503356	ZD03-28.0-XP25-WC05-02	89	60	175	28	1038				
503358	ZD03-28.5-XP25-WC05-02	90.5	60	176	28.5	1038				
503360	ZD03-29.0-XP25-WC05-02	92	60	178	29	1038				
503362	ZD03-29.5-XP25-WC05-02	93.5	60	179	29.5	1038				
503364	ZD03-30.0-XP25-WC05-02	95	60	181	30	1038				
503366	ZD03-30.5-XP25-WC05-02	96.5	60	182	30.5	1213				
503368	ZD03-31.0-XP25-WC05-02	98	60	184	31	1213				
503370	ZD03-31.5-XP25-WC05-02	99.5	60	185	31.5	1213				
503372	ZD03-32.0-XP25-WC05-02	101	60	187	32	1213				
503374	ZD03-32.5-XP25-WC05-02	102.5	60	188	32.5	1213				
503376	ZD03-33.0-XP25-WC06-02	104	60	190	33	1213				
503378	ZD03-33.5-XP25-WC06-02	105.5	60	191	33.5	1213				
503380	ZD03-34.0-XP25-WC06-02	107	60	193	34	1213				
503382	ZD03-34.5-XP25-WC06-02	108.5	60	194	34.5	1213				
503384	ZD03-35.0-XP25-WC06-02	110	60	196	35	1213				
503386	ZD03-35.5-XP25-WC06-02	111.5	60	197	35.5	1325				
503388	ZD03-36.0-XP25-WC06-02	113	60	199	36	1325				
503390	ZD03-36.5-XP25-WC06-02	114.5	60	200	36.5	1325				
503392	ZD03-37.0-XP25-WC06-02	116	60	202	37	1325				
503394	ZD03-37.5-XP25-WC06-02	117.5	60	203	37.5	1325				
503396	ZD03-38.0-XP25-WC06-02	119	60	205	38	1325				
503398	ZD03-38.5-XP25-WC06-02	120.5	60	206	38.5	1325				
503400	ZD03-39.0-XP25-WC06-02	122	60	206	39	1325				
503402	ZD03-39.5-XP25-WC06-02	123.5	60	209	39.5	1325				
503404	ZD03-40.0-XP25-WC06-02	125	60	211	40	1325				
503406	ZD03-41.0-XP25-WC06-02	128	60	214	41	1525				
503408	ZD03-42.0-XP25-WC06-02	131	60	217	42	1525				
503410	ZD03-43.0-XP40-WC08-02	134	65	229	43	1525				
503412	ZD03-44.0-XP40-WC08-02	137	65	232	44	1525				
503414	ZD03-45.0-XP40-WC08-02	140	65	235	45	1525				
503416	ZD03-46.5-XP40-WC08-02	143	65	238	46	1725				
503418	ZD03-47.0-XP40-WC08-02	146	65	241	47	1725				
503420	ZD03-48.0-XP40-WC08-02	149	65	244	48	1725				
503422	ZD03-49.0-XP40-WC08-02	152	65	247	49	1725				
503424	ZD03-50.0-XP40-WC08-02	155	65	250	50	1725				
503426	ZD03-51.0-XP40-WC08-02	158	65	253	51	1950				
503428	ZD03-52.0-XP40-WC08-02	161	65	256	52	1950				
503430	ZD03-53.0-XP40-WC08-02	164	65	259	53	1950				
503432	ZD03-54.0-XP40-WC08-02	167	65	262	54	1950				
503434	ZD03-55.0-XP40-WC08-02	170	65	265	55	1950				
503436	ZD03-56.0-XP40-WC08-02	173	65	268	56	2150				
503438	ZD03-57.0-XP40-WC08-02	176	65	271	57	2150				
503440	ZD03-58.0-XP40-WC06-04	179	65	274	58	2150				
503442	ZD03-59.0-XP40-WC06-04	182	65	277	59	2150				
503444	ZD03-60.0-XP40-WC06-04	185	65	280	60	2150				
503446	ZD03-61.0-XP40-WC06-04	188	65	283	61	2150				
503448	ZD03-62.0-XP40-WC06-04	191	65	286	62	2150				
503450	ZD03-63.0-XP40-WC06-04	194	65	289	63	2150				
503452	ZD03-64.0-XP40-WC06-04	197	65	292	64	2150				
503454	ZD03-65.0-XP40-WC06-04	200	65	295	65	2150				

快速钻头切削数据参考表

快钻直径 Diameter	材质 Material
------------------	----------------

舍弃式钻头

Abandon Type Drill

住友WC型舍弃式快速钻头

4倍快速钻头 -WC刀片

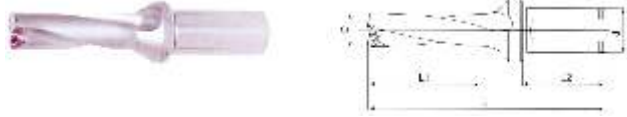

5倍快速钻头 -WC刀片



Order	型号 Model	L1	L2	L	D	d	适用刀片 Applicable Insert	螺丝 screw	扳手 Wrench	Price
503500	ZD04-14.0-XP25-WC03-02	61	56	134	14	25	WCMT030208	M 2.5 x 6T.8	T 8	825
503502	ZD04-14.5-XP25-WC03-02	63	56	136	14.5					825
503504	ZD04-15.0-XP25-WC03-02	65	56	138	15					825
503506	ZD04-15.5-XP25-WC03-02	67	56	140	15.5					825
503508	ZD04-16.0-XP25-WC03-02	69	56	142	16					825
503510	ZD04-16.5-XP25-WC03-02	71	56	144	16.5					825
503512	ZD04-17.0-XP25-WC03-02	73	56	146	17					825
503514	ZD04-17.5-XP25-WC03-02	75	56	148	17.5					825
503516	ZD04-18.0-XP25-WC03-02	77	56	150	18					825
503518	ZD04-18.5-XP25-WC03-02	79	56	152	18.5					825
503520	ZD04-19.0-XP25-WC03-02	81	56	154	19	825				
503522	ZD04-19.5-XP25-WC03-02	83	56	156	19.5	825				
503524	ZD04-20.0-XP25-WC03-02	85	56	158	20	825				
503526	ZD04-20.5-XP25-WC03-02	87	56	161	20.5	1025				
503528	ZD04-21.0-XP25-WC03-02	89	56	163	21	1025				
503530	ZD04-21.5-XP25-WC04-02	91	56	165	21.5	1025				
503532	ZD04-22.0-XP25-WC04-02	93	56	167	22	1025				
503534	ZD04-22.5-XP25-WC04-02	95	56	169	22.5	1025				
503536	ZD04-23.0-XP25-WC04-02	97	56	171	23	1025				
503538	ZD04-23.5-XP25-WC04-02	99	56	173	23.5	1025				
503540	ZD04-24.0-XP25-WC04-02	101	56	175	24	1025				
503542	ZD04-24.5-XP25-WC04-02	103	56	177	24.5	1025				
503544	ZD04-25.0-XP32-WC03-02	105	60	191	25	1150				
503546	ZD04-25.5-XP32-WC03-02	107	60	193	25.5	1150				
503548	ZD04-26.0-XP32-WC03-02	109	60	195	26	1150				
503550	ZD04-26.5-XP32-WC03-02	111	60	197	26.5	1150				
503552	ZD04-27.0-XP32-WC03-02	113	60	199	27	1150				
503554	ZD04-27.5-XP32-WC03-02	115	60	201	27.5	1150				
503556	ZD04-28.0-XP32-WC03-02	117	60	203	28	1150				
503558	ZD04-28.5-XP32-WC03-02	119	60	205	28.5	1150				
503560	ZD04-29.0-XP32-WC03-02	121	60	207	29	1150				
503562	ZD04-29.5-XP32-WC03-02	123	60	209	29.5	1150				
503564	ZD04-30.0-XP32-WC03-02	125	60	211	30	1150				
503566	ZD04-30.5-XP32-WC03-02	127	60	213	30.5	1325				
503568	ZD04-31.0-XP32-WC03-02	129	60	215	31	1325				
503570	ZD04-31.5-XP32-WC03-02	131	60	217	31.5	1325				
503572	ZD04-32.0-XP32-WC03-02	133	60	219	32	1325				
503574	ZD04-32.5-XP32-WC06-02	135	60	221	32.5	1325				
503576	ZD04-33.0-XP32-WC06-02	137	60	223	33	1325				
503578	ZD04-33.5-XP32-WC06-02	139	60	225	33.5	1325				
503580	ZD04-34.0-XP32-WC06-02	141	60	227	34	1325				
503582	ZD04-34.5-XP32-WC06-02	143	60	229	34.5	1325				
503584	ZD04-35.0-XP32-WC06-02	145	60	231	35	1475				
503586	ZD04-35.5-XP32-WC06-02	147	60	233	35.5	1475				
503588	ZD04-36.0-XP32-WC06-02	149	60	235	36	1475				
503590	ZD04-36.5-XP32-WC06-02	151	60	237	36.5	1475				
503592	ZD04-37.0-XP32-WC06-02	153	60	239	37	1475				
503594	ZD04-37.5-XP32-WC06-02	155	60	241	37.5	1475				
503596	ZD04-38.0-XP32-WC06-02	157	60	243	38	1475				
503598	ZD04-38.5-XP32-WC06-02	159	60	245	38.5	1475				
503600	ZD04-39.0-XP32-WC06-02	161	60	247	39	1475				
503602	ZD04-39.5-XP32-WC06-02	163	60	249	39.5	1475				
503604	ZD04-40.0-XP32-WC06-02	165	60	251	40	1700				
503606	ZD04-41.0-XP32-WC06-02	169	60	255	41	1700				
503608	ZD04-42.0-XP32-WC06-02	173	60	259	42	1700				
503610	ZD04-43.0-XP40-WC08-02	177	65	272	43	1700				
503612	ZD04-44.0-XP40-WC08-02	181	65	276	44	1700				
503614	ZD04-45.0-XP40-WC08-02	185	65	280	44	1700				
503616	ZD04-46.0-XP40-WC08-02	189	65	284	46	1900				
503618	ZD04-47.0-XP40-WC08-02	193	65	288	47	1900				
503620	ZD04-48.0-XP40-WC08-02	197	65	292	48	1900				
503622	ZD04-49.0-XP40-WC08-02	201	65	296	49	1900				
503624	ZD04-50.0-XP40-WC08-02	205	65	300	50	1900				
503626	ZD04-51.0-XP40-WC08-02	209	65	304	51	2150				
503628	ZD04-52.0-XP40-WC08-02	213	65	308	52	2150				
503630	ZD04-53.0-XP40-WC08-02	217	65	312	53	2150				
503632	ZD04-54.0-XP40-WC08-02	221	65	316	54	2150				
503634	ZD04-55.0-XP40-WC08-02	225	65	320	55	2150				
503636	ZD04-56.0-XP40-WC08-02	229	65	324	56	2375				
503638	ZD04-57.0-XP40-WC08-02	233	65	328	57	2375				
503640	ZD04-58.0-XP40-WC06-04	237	65	332	58	2375				
503642	ZD04-59.0-XP40-WC06-04	241	65	336	59	2375				
503644	ZD04-60.0-XP40-WC06-04	245	65	340	60	2375				
503646	ZD04-61.0-XP40-WC06-04	249	65	344	61	2375				
503648	ZD04-62.0-XP40-WC06-04	253	65	348	62	2375				
503650	ZD04-63.0-XP40-WC06-04	257	65	352	63	2375				
503652	ZD04-64.0-XP40-WC06-04	261	65	356	64	2375				
503654	ZD04-65.0-XP40-WC06-04	265	65	360	65	2375				

Order	型号 Model	L1	L2	L	D	d	适用刀片 Applicable Insert	螺丝 screw	扳手 Wrench	Price
503700	ZD05-14.0-XP25-WC03-02	75	56	148	14	25	WCMT030208	M 2.5 x 6T.8	T 8	950
503702	ZD05-14.5-XP25-WC03-02	77.5	56	150	14.5					950
503704	ZD05-15.0-XP25-WC03-02	80	56	153	15					950
503706	ZD05-15.5-XP25-WC03-02	82.5	56	155	15.5					950
503708	ZD05-16.0-XP25-WC03-02	85	56	158	16					950
503710	ZD05-16.5-XP25-WC03-02	87.5	56	160	16.5					950
503712	ZD05-17.0-XP25-WC03-02	90	56	163	17					950
503714	ZD05-17.5-XP25-WC03-02	92.5	56	165	17.5					950
503716	ZD05-18.0-XP25-WC03-02	95	56	168	18					950
503718	ZD05-18.5-XP25-WC03-02	97.5	56	170	18.5					950
503720	ZD05-19.0-XP25-WC03-02	100	56	173	19	950				
503722	ZD05-19.5-XP25-WC03-02	102.5	56	174	19.5	950				
503724	ZD05-20.0-XP25-WC03-02	105	56	179	20	950				
503726	ZD05-20.5-XP25-WC03-02	107.5	56	181	20.5	1150				
503728	ZD05-21.0-XP25-WC04-02	110	56	184	21	1150				
503730	ZD05-21.5-XP25-WC04-02	112.5	56	186	21.5	1150				
503732	ZD05-22.0-XP25-WC04-02	115	56	189	22	1150				
503734	ZD05-22.5-XP25-WC04-02	117.5	56	193	22.5	1150				
503736	ZD05-23.0-XP25-WC04-02	120	56	194	23	1150				
503738	ZD05-23.5-XP25-WC04-02	122.5	56	196	23.5	1150				
503740	ZD05-24.0-XP25-WC04-02	125	56	199	24	1150				
503742	ZD05-24.5-XP25-WC04-02	127.5	56	201	24.5	1150				
503744	ZD05-25.0-XP32-WC05-02	130	60	216	25	1150				
503746	ZD05-25.5-XP32-WC05-02	132.5	60	218	25.5	1300				
503748	ZD05-26.0-XP32-WC05-02	135	60	221	26	1300				
503750	ZD05-26.5-XP32-WC05-02	137.5	60	223	26.5	1300				
503752	ZD05-27.0-XP32-WC05-02	140	60	226	27	1300				
503754	ZD05-27.5-XP32-WC05-02	142.5	60	228	27.5	1300				
503756	ZD05-28.0-XP32-WC05-02	145	60	231	28	1300				
503758	ZD05-28.5-XP32-WC05-02	147.5	60	233	28.5	1300				
503760	ZD05-29.0-XP32-WC05-02	150	60	236	29	1300				
503762	ZD05-29.5-XP32-WC05-02	152.5	60	238	29.5	1300				
503764	ZD05-30.0-XP32-WC05-02	155	60	241	30	1300				
503766	ZD05-30.5-XP32-WC05-02	157.5	60	243	30.5	1450				
503768	ZD05-31.0-XP32-WC05-02	160	60	246	31	1450				
503770	ZD05-31.5-XP32-WC05-02	162.5	60	248	31.5	1450				
503772	ZD05-32.0-XP32-WC06-02	165	60	251	32	1450				
503774	ZD05-32.5-XP32-WC06-02	167.5	60	253	32.5	1450				
503776	ZD05-33.0-XP32-WC06-02	170	60	256	33	1450				
503778	ZD05-33.5-XP32-WC06-02	172.5	60	258	33.5	1450				
503780	ZD05-34.0-XP32-WC06-02	175	60	261	34	1450				
503782	ZD05-34.5-XP32-WC06-02	177.5	60	263	34.5	1450				
503784	ZD05-35.0-XP32-WC06-02	180	60	266	35	1450				
503786	ZD05-35.5-XP32-WC06-02	182.5	60	268	35.5	1600				
503788	ZD05-36.0-XP32-WC06-02	185	60	271	36	1600				
503790	ZD05-36.5-XP32-WC06-02	187.5	60	273	36.5	1600				
503792	ZD05-37.0-XP32-WC06-02	190	60	276	37	1600				
503794	ZD05-37.5-XP32-WC06-02	192.5	60	278	37.5	1600				
503796	ZD05-38.0-XP32-WC06-02	195	60	281	38	1600				
503798	ZD05-38.5-XP32-WC06-02	197.5	60	283	38.5	1600				
503800	ZD05-39.0-XP32-WC06-02	200	60	284	39	1600				
503802	ZD05-39.5-XP32-WC06-02	202.5	60	288	39.5	1600				
503804	ZD05-40.0-XP32-WC06-02	205	60	291	40	1600				
503806	ZD05-41.0-XP32-WC06-02	210	60	296	41	1900				
503808	ZD05-42.0-XP32-WC06-02	215	60	301	42	1900				
503810	ZD05-43.0-XP40-WC08-02	220	65	315	43	1900				
503812	ZD05-44.0-XP40-WC08-02	225	65	320	44	1900				
503814	ZD05-45.0-XP40-WC08-02	230	65	325	45	1900				
503816	ZD05-46.0-XP40-WC08-02	235	65	330	46	2100				
503818	ZD05-47.0-XP40-WC08-02	240	65	335	47	2100				
503820	ZD05-48.0-XP40-WC08-02	245	65	340	48	2100				
503822	ZD05-49.0-XP40-WC08-02	250	65	345	49	2100				
503824	ZD05-50.0-XP40-WC08-02	255	65	350	50	2100				
503826	ZD05-51.0-XP40-WC08-02	260	65	355	51	2300				
503828	ZD05-52.0-XP40-WC08-02	265	65	360	52	2300				
503830	ZD05-53.0-XP40-WC08-02	270	65	365	53	2300				
503832	ZD05-54.0-XP40-WC08-02	275	65	370	54	2300				
503834	ZD05-55.0-XP40-WC08-02	280	65	375	55	2300				
5										

特固克SP型舍弃式快速钻头

2倍快速钻头 - SP刀片



3倍快速钻头 - SP刀片

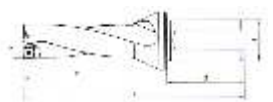

Order	型号 Model	L1	L2	L	D	d	适用刀片 Applicable Insert	螺丝 screw	扳手 Wrench	Price
504100	ZD02-13.0-XP25-SP05-02	31	56	104	13	25	SPMG050204	M2 x 5	T6	700
504102	ZD02-14.0-XP25-SP05-02	33	56	106	14					700
504104	ZD02-15.0-XP25-SP05-02	35	56	108	15					700
504106	ZD02-16.0-XP25-SP06-02	37	56	110	16					700
504108	ZD02-17.0-XP25-SP06-02	39	56	112	17					700
504110	ZD02-18.0-XP25-SP06-02	41	56	114	18					700
504112	ZD02-19.0-XP25-SP06-02	43	56	116	19		700			
504114	ZD02-20.0-XP25-SP06-02	45	56	118	20		700			
504116	ZD02-21.0-XP25-SP06-02	47	56	121	21		875			
504118	ZD02-22.0-XP25-SP07-02	49	56	123	22		875			
504120	ZD02-23.0-XP25-SP07-02	51	56	125	23		875			
504122	ZD02-24.0-XP25-SP07-02	53	56	127	24		875			
504124	ZD02-25.0-XP32-SP07-02	55	60	141	25	875				
504126	ZD02-26.0-XP32-SP07-02	57	60	143	26	988				
504128	ZD02-27.0-XP32-SP07-02	59	60	145	27	988				
504130	ZD02-28.0-XP32-SP09-02	61	60	147	28	988				
504132	ZD02-29.0-XP32-SP09-02	63	60	149	29	988				
504134	ZD02-30.0-XP32-SP09-02	65	60	151	30	988				
504136	ZD02-31.0-XP32-SP09-02	67	60	153	31	1150				
504138	ZD02-32.0-XP32-SP09-02	69	60	155	32	1150				
504140	ZD02-33.0-XP32-SP09-02	71	60	157	33	1150				
504142	ZD02-34.0-XP32-SP11-02	73	60	159	34	1150				
504144	ZD02-35.0-XP32-SP11-02	75	60	161	35	1150				
504146	ZD02-36.0-XP32-SP11-02	77	60	163	36	1258				
504148	ZD02-37.0-XP32-SP11-02	79	60	165	37	1258				
504150	ZD02-38.0-XP32-SP11-02	81	60	167	38	1258				
504152	ZD02-39.0-XP32-SP11-02	83	60	169	39	1258				
504154	ZD02-40.0-XP32-SP11-02	85	60	171	40	1258				
504156	ZD02-41.0-XP32-SP14-02	87	60	173	41	1450				
504158	ZD02-42.0-XP32-SP14-02	89	60	175	42	1450				
504160	ZD02-43.0-XP40-SP14-02	91	65	186	43	1450				
504162	ZD02-44.0-XP40-SP14-02	93	65	188	44	1450				
504164	ZD02-45.0-XP40-SP14-02	95	65	190	45	1638				
504166	ZD02-46.0-XP40-SP14-02	97	65	192	46	1638				
504168	ZD02-47.0-XP40-SP14-02	99	65	194	47	1638				
504170	ZD02-48.0-XP40-SP07-04	101	65	196	48	1638				
504172	ZD02-49.0-XP40-SP07-04	103	65	198	49	1638				
504174	ZD02-50.0-XP40-SP07-04	105	65	200	50	1853				
504176	ZD02-51.0-XP40-SP07-04	107	65	202	51	1853				
504178	ZD02-52.0-XP40-SP09-04	109	65	204	52	1853				
504180	ZD02-53.0-XP40-SP09-04	111	65	206	53	1853				
504182	ZD02-54.0-XP40-SP09-04	113	65	208	54	1853				
504184	ZD02-55.0-XP40-SP09-04	115	65	210	55	2043				
504186	ZD02-56.0-XP40-SP09-04	117	65	212	56	2043				
504188	ZD02-57.0-XP40-SP09-04	119	65	214	57	2043				
504190	ZD02-58.0-XP40-SP09-04	121	65	216	58	2043				
504192	ZD02-59.0-XP40-SP09-04	123	65	218	59	2043				
504194	ZD02-60.0-XP40-SP09-04	125	65	220	60	2043				

Order	型号 Model	L1	L2	L	D	d	适用刀片 Applicable Insert	螺丝 screw	扳手 Wrench	Price
504200	ZD03-13.0-XP25-SP05-02	44	56	117	13	25	SPMG050204	M2 x 5	T6	738
504202	ZD03-13.5-XP25-SP05-02	45.5	56	118	13.5					738
504204	ZD03-14.0-XP25-SP05-02	47	56	120	14					738
504206	ZD03-14.5-XP25-SP05-02	48.5	56	122	14.5					738
504208	ZD03-15.0-XP25-SP05-02	50	56	123	15					738
504210	ZD03-15.5-XP25-SP06-02	51.5	56	124	15.5					738
504212	ZD03-16.0-XP25-SP06-02	53	56	126	16		738			
504214	ZD03-16.5-XP25-SP06-02	54.5	56	127	16.5		738			
504216	ZD03-17.0-XP25-SP06-02	56	56	129	17		738			
504218	ZD03-17.5-XP25-SP06-02	57.5	56	130	17.5		738			
504220	ZD03-18.0-XP25-SP06-02	59	56	132	18		738			
504222	ZD03-18.5-XP25-SP06-02	60.5	56	133	18.5		738			
504224	ZD03-19.0-XP25-SP06-02	62	56	135	19	738				
504226	ZD03-19.5-XP25-SP06-02	63.5	56	136	19.5	738				
504228	ZD03-20.0-XP25-SP06-02	65	56	139	20	925				
504230	ZD03-20.5-XP25-SP06-02	66.5	56	140	20.5	925				
504232	ZD03-21.0-XP25-SP06-02	68	56	142	21	925				
504234	ZD03-21.5-XP25-SP06-02	69.5	56	143	21.5	925				
504236	ZD03-22.0-XP25-SP07-02	71	56	145	22	925				
504238	ZD03-22.5-XP25-SP07-02	72.5	56	148	22.5	925				
504240	ZD03-23.0-XP25-SP07-02	74	56	148	23	925				
504242	ZD03-23.5-XP25-SP07-02	75.5	56	149	23.5	925				
504244	ZD03-24.0-XP25-SP07-02	77	56	151	24	925				
504246	ZD03-24.5-XP25-SP07-02	78.5	56	152	24.5	925				
504248	ZD03-25.0-XP32-SP07-02	80	60	166	25	925				
504250	ZD03-25.5-XP32-SP07-02	81.5	60	167	25.5	1038				
504252	ZD03-26.0-XP32-SP07-02	83	60	169	26	1038				
504254	ZD03-26.5-XP32-SP07-02	84.5	60	170	26.5	1038				
504256	ZD03-27.0-XP32-SP07-02	86	60	172	27	1038				
504258	ZD03-27.5-XP32-SP07-02	87.5	60	173	27.5	1038				
504260	ZD03-28.0-XP32-SP09-02	89	60	175	28	1038				
504262	ZD03-28.5-XP32-SP09-02	90.5	60	176	28.5	1038				
504264	ZD03-29.0-XP32-SP09-02	92	60	178	29	1038				
504266	ZD03-29.5-XP32-SP09-02	93.5	60	179	29.5	1038				
504268	ZD03-30.0-XP32-SP09-02	95	60	181	30	1213				
504270	ZD03-30.5-XP32-SP09-02	96.5	60	182	30.5	1213				
504272	ZD03-31.0-XP32-SP09-02	98	60	184	31	1213				
504274	ZD03-31.5-XP32-SP09-02	99.5	60	185	31.5	1213				
504276	ZD03-32.0-XP32-SP09-02	101	60	187	32	1213				
504278	ZD03-32.5-XP32-SP09-02	102.5	60	188	32.5	1213				
504280	ZD03-33.0-XP32-SP09-02	104	60	190	33	1213				
504282	ZD03-33.5-XP32-SP09-02	105.5	60	191	33.5	1213				
504284	ZD03-34.0-XP32-SP11-02	107	60	193	34	1213				
504286	ZD03-34.5-XP32-SP11-02	108.5	60	194	34.5	1213				
504288	ZD03-35.0-XP32-SP11-02	110	60	196	35	1213				
504290	ZD03-35.5-XP32-SP11-02	111.5	60	197	35.5	1325				
504292	ZD03-36.0-XP32-SP11-02	113	60	199	36	1325				
504294	ZD03-36.5-XP32-SP11-02	114.5	60	200	36.5	1325				
504296	ZD03-37.0-XP32-SP11-02	116	60	202	37	1325				
504298	ZD03-37.5-XP32-SP11-02	117.5	60	203	37.5	1325				
504300	ZD03-38.0-XP32-SP11-02	119	60	205	38	1325				
504302	ZD03-38.5-XP32-SP11-02	120.5	60	206	38.5	1325				
504304	ZD03-39.0-XP32-SP11-02	122	60	206	39	1325				
504306	ZD03-39.5-XP32-SP11-02	123.5	60	209	39.5	1325				
504308	ZD03-40.0-XP32-SP11-02	125	60	211	40	1325				
504310	ZD03-41.0-XP32-SP14-02	128	60	214	41	1525				
504312	ZD03-42.0-XP32-SP14-02	131	60	217	42	1525				
504314	ZD03-43.0-XP40-SP14-02	134	65	229	43	1525				
504316	ZD03-44.0-XP40-SP14-02	137	65	232	44	1525				
504318	ZD03-45.0-XP40-SP14-02	140	65	235	45	1525				
504320	ZD03-46.0-XP40-SP14-02	143	65	238	46	1725				
504322	ZD03-47.0-XP40-SP14-02	146	65	241	47	1725				
504324	ZD03-48.0-XP40-SP07-04	149	65	244	48	1725				
504326	ZD03-49.0-XP40-SP07-04	152	65	247	49	1725				
504328	ZD03-50.0-XP40-SP07-04	155	65	250	50	1950				
504330	ZD03-51.0-XP40-SP07-04	158	65	253	51	1950				
504332	ZD03-52.0-XP40-SP09-04	161	65	256	52	1950				
504334	ZD03-53.0-XP40-SP09-04	164	65	259	53	1950				
504336	ZD03-54.0-XP40-SP09-04	167	65	262	54	1950				
504338	ZD03-55.0-XP40-SP09-04	170	65	265	55	1950				
504340	ZD03-56.0-XP40-SP09-04	173	65	268	56	2150				
504342	ZD03-57.0-XP40-SP09-04	176	65	271	57	2150				
504344	ZD03-58.0-XP40-SP09-04	179	65	274	58	2150				
504346	ZD03-59.0-XP40-SP09-04	182	65	277	59	2150				
504348	ZD03-60.0-XP40-SP09-04	185	65	280	60	2150				

冷却液流量 (l/min)

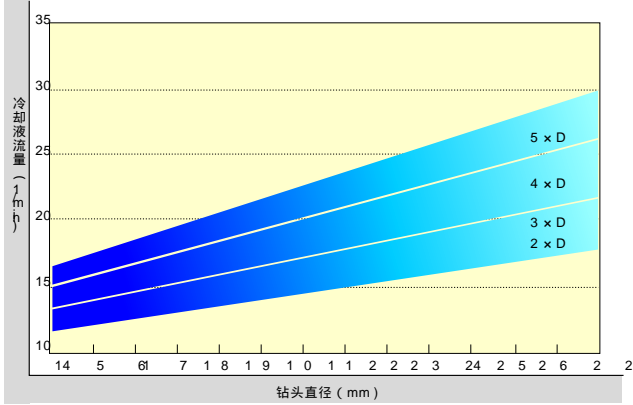

加工功率要求

- 以下图表为钻削加工所需切削力
- U-Drill 用于离耐性离功率机床

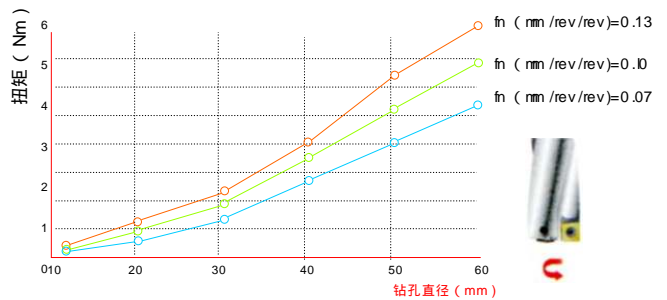
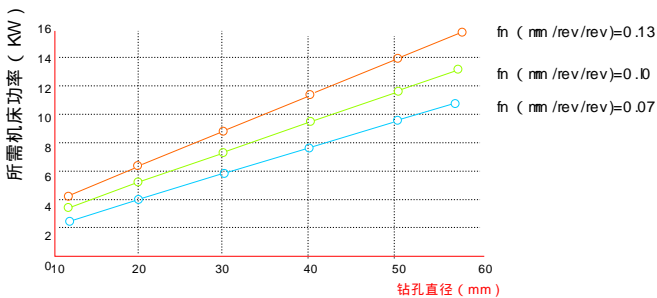

C

舍弃式钻头

Abandon Type Drill

特固克SP型舍弃式快速钻头

4倍快速钻头 - SP刀片



5倍快速钻头 - SP刀片

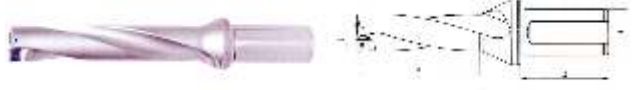

Order	型号 Model	L1	L2	L	D	d	适用刀片 Applicable O insert	螺丝 screw	扳手 Wrench	Price
504400	ZD04-13.0-XP25-SP05-02	57	56	130	13	25	SPMG060204	M2 x 5	T6	825
504402	ZD04-13.5-XP25-SP05-02	59	56	132	13.5					825
504404	ZD04-14.0-XP25-SP05-02	61	56	134	14					825
504406	ZD04-14.5-XP25-SP05-02	63	56	136	14.5					825
504408	ZD04-15.0-XP25-SP05-02	65	56	138	15					825
504410	ZD04-15.5-XP25-SP06-02	67	56	140	15.5					825
504412	ZD04-16.0-XP25-SP06-02	69	56	142	16					825
504414	ZD04-16.5-XP25-SP06-02	71	56	144	16.5					825
504416	ZD04-17.0-XP25-SP06-02	73	56	146	17					825
504418	ZD04-17.5-XP25-SP06-02	75	56	148	17.5					825
504420	ZD04-18.0-XP25-SP06-02	77	56	150	18		825			
504422	ZD04-18.5-XP25-SP06-02	79	56	152	18.5		825			
504424	ZD04-19.0-XP25-SP06-02	81	56	154	19		825			
504426	ZD04-19.5-XP25-SP06-02	83	56	155	19.5		825			
504428	ZD04-20.0-XP25-SP06-02	85	56	159	20		825			
504430	ZD04-20.5-XP25-SP06-02	87	56	161	20.5		1025			
504432	ZD04-21.0-XP25-SP06-02	89	56	163	21		1025			
504434	ZD04-21.5-XP25-SP06-02	91	56	165	21.5		1025			
504436	ZD04-22.0-XP25-SP07-02	93	56	167	22		1025			
504438	ZD04-22.5-XP25-SP07-02	95	56	169	22.5		1025			
504440	ZD04-23.0-XP25-SP07-02	97	56	171	23		1025			
504442	ZD04-23.5-XP25-SP07-02	99	56	173	23.5		1025			
504444	ZD04-24.0-XP25-SP07-02	101	56	175	24		1025			
504446	ZD04-24.5-XP25-SP07-02	103	56	177	24.5		1025			
504448	ZD04-25.0-XP32-SP07-02	105	60	191	25		1025			
504450	ZD04-25.5-XP32-SP07-02	107	60	193	25.5	1150				
504452	ZD04-26.0-XP32-SP07-02	109	60	195	26	1150				
504454	ZD04-26.5-XP32-SP07-02	111	60	197	26.5	1150				
504456	ZD04-27.0-XP32-SP07-02	113	60	199	27	1150				
504458	ZD04-27.5-XP32-SP07-02	115	60	201	27.5	1150				
504460	ZD04-28.0-XP32-SP09-02	117	60	203	28	1150				
504462	ZD04-28.5-XP32-SP09-02	119	60	205	28.5	1150				
504464	ZD04-29.0-XP32-SP09-02	121	60	207	29	1150				
504466	ZD04-29.5-XP32-SP09-02	123	60	209	29.5	1150				
504468	ZD04-30.0-XP32-SP09-02	125	60	211	30	1150				
504470	ZD04-30.5-XP32-SP09-02	127	60	213	30.5	1325				
504472	ZD04-31.0-XP32-SP09-02	129	60	215	31	1325				
504474	ZD04-31.5-XP32-SP09-02	131	60	217	31.5	1325				
504476	ZD04-32.0-XP32-SP09-02	133	60	219	32	1325				
504478	ZD04-32.5-XP32-SP09-02	135	60	221	32.5	1325				
504480	ZD04-33.0-XP32-SP09-02	137	60	223	33	1325				
504482	ZD04-33.5-XP32-SP09-02	139	60	225	33.5	1325				
504484	ZD04-34.0-XP32-SP11-02	141	60	227	34	1325				
504486	ZD04-34.5-XP32-SP11-02	143	60	229	34.5	1325				
504488	ZD04-35.0-XP32-SP11-02	145	60	231	35	1325				
504490	ZD04-35.5-XP32-SP11-02	147	60	233	35.5	1475				
504492	ZD04-36.0-XP32-SP11-02	149	60	235	36	1475				
504494	ZD04-36.5-XP32-SP11-02	151	60	237	36.5	1475				
504496	ZD04-37.0-XP32-SP11-02	153	60	239	37	1475				
504498	ZD04-37.5-XP32-SP11-02	155	60	241	37.5	1475				
504500	ZD04-38.0-XP32-SP11-02	157	60	243	38	1475				
504502	ZD04-38.5-XP32-SP11-02	159	60	245	38.5	1475				
504504	ZD04-39.0-XP32-SP11-02	161	60	247	39	1475				
504506	ZD04-39.5-XP32-SP11-02	163	60	249	39.5	1475				
504508	ZD04-40.0-XP32-SP11-02	165	60	251	40	1475				
504510	ZD04-41.0-XP32-SP14-02	169	60	255	41	1700				
504512	ZD04-42.0-XP32-SP14-02	173	60	259	42	1700				
504514	ZD04-43.0-XP40-SP14-02	177	65	272	43	1700				
504516	ZD04-44.0-XP40-SP14-02	181	65	276	44	1700				
504518	ZD04-45.0-XP40-SP14-02	185	65	280	45	1900				
504520	ZD04-46.0-XP40-SP14-02	189	65	284	46	1900				
504522	ZD04-47.0-XP40-SP14-02	193	65	288	47	1900				
504524	ZD04-48.0-XP40-SP07-04	197	65	292	48	1900				
504526	ZD04-49.0-XP40-SP07-04	201	65	296	49	1900				
504528	ZD04-50.0-XP40-SP07-04	205	65	300	50	1900				
504530	ZD04-51.0-XP40-SP07-04	209	65	304	51	2150				
504532	ZD04-52.0-XP40-SP09-04	213	65	308	52	2150				
504534	ZD04-53.0-XP40-SP09-04	217	65	312	53	2150				
504536	ZD04-54.0-XP40-SP09-04	221	65	316	54	2150				
504538	ZD04-55.0-XP40-SP09-04	225	65	320	55	2150				
504540	ZD04-56.0-XP40-SP09-04	229	65	324	56	2375				
504542	ZD04-57.0-XP40-SP09-04	233	65	328	57	2375				
504544	ZD04-58.0-XP40-SP09-04	237	65	332	58	2375				
504546	ZD04-59.0-XP40-SP09-04	241	65	336	59	2375				
504548	ZD04-60.0-XP40-SP09-04	245	65	340	60	2375				

Order	型号 Model	L1	L2	L	D	d	适用刀片 Applicable O insert	螺丝 screw	扳手 Wrench	Price
504600	ZD05-13.0-XP25-SP05-02	70	56	143	13	25	SPMG050204	M2 x 5	T6	950
504602	ZD05-13.5-XP25-SP05-02	72.5	56	145	13.5					950
504604	ZD05-14.0-XP25-SP05-02	75	56	148	14					950
504606	ZD05-14.5-XP25-SP05-02	77.5	56	150	14.5					950
504608	ZD05-15.0-XP25-SP05-02	80	56	153	15					950
504610	ZD05-15.5-XP25-SP06-02	82.5	56	155	15.5					950
504612	ZD05-16.0-XP25-SP06-02	85	56	158	16					950
504614	ZD05-16.5-XP25-SP06-02	87.5	56	160	16.5					950
504616	ZD05-17.0-XP25-SP06-02	90	56	163	17					950
504618	ZD05-17.5-XP25-SP06-02	92.5	56	165	17.5					950
504620	ZD05-18.0-XP25-SP06-02	95	56	168	18		950			
504622	ZD05-18.5-XP25-SP06-02	97.5	56	170	18.5		950			
504624	ZD05-19.0-XP25-SP06-02	100	56	173	19		950			
504626	ZD05-19.5-XP25-SP06-02	102.5	56	174	19.5		950			
504628	ZD05-20.0-XP25-SP06-02	105	56	179	20		1150			
504630	ZD05-20.5-XP25-SP06-02	107.5	56	181	20.5		1150			
504632	ZD05-21.0-XP25-SP06-02	110	56	184	21		1150			
504634	ZD05-21.5-XP25-SP06-02	112.5	56	186	21.5		1150			
504636	ZD05-22.0-XP25-SP07-02	115	56	189	22		1150			
504638	ZD05-22.5-XP25-SP07-02	117.5	56	193	22.5		1150			
504640	ZD05-23.0-XP25-SP07-02	120	56	194	23		1150			
504642	ZD05-23.5-XP25-SP07-02	122.5	56	196	23.5		1150			
504644	ZD05-24.0-XP25-SP07-02	125	56	199	24		1150			
504646	ZD05-24.5-XP25-SP07-02	127.5	56	201	24.5		1150			
504648	ZD05-25.0-XP32-SP07-02	130	60	216	25		1150			
504650	ZD05-25.5-XP32-SP07-02	132.5	60	218	25.5	1300				
504652	ZD05-26.0-XP32-SP07-02	135	60	221	26	1300				
504654	ZD05-26.5-XP32-SP07-02	137.5	60	223	26.5	1300				
504656	ZD05-27.0-XP32-SP07-02	140	60	226	27	1300				
504658	ZD05-27.5-XP32-SP07-02	142.5	60	228	27.5	1300				
504660	ZD05-28.0-XP32-SP09-02	145	60	231	28	1300				
504662	ZD05-28.5-XP32-SP09-02	147.5	60	233	28.5	1300				
504664	ZD05-29.0-XP32-SP09-02	150	60	236	29	1300				
504666	ZD05-29.5-XP32-SP09-02	152.5	60	238	29.5	1300				
504668	ZD05-30.0-XP32-SP09-02	155	60	241	30	1300				
504670	ZD05-30.5-XP32-SP09-02	157.5	60	243	30.5	1450				
504672	ZD05-31.0-XP32-SP09-02	160	60	246	31	1450				
504674	ZD05-31.5-XP32-SP09-02	162.5	60	248	31.5	1450				
504676	ZD05-32.0-XP32-SP09-02	165	60	251	32	1450				
504678	ZD05-32.5-XP32-SP09-02	167.5	60	253	32.5	1450				
504680	ZD05-33.0-XP32-SP09-02	170	60	256	33	1450				
504682	ZD05-33.5-XP32-SP09-02	172.5	60	258	33.5	1450				
504684	ZD05-34.0-XP32-SP11-02	175	60	261	34	1450				
504686	ZD05-34.5-XP32-SP11-02	177.5	60	263	34.5	1450				
504688	ZD05-35.0-XP32-SP11-02	180	60	266	35	1450				
504690	ZD05-35.5-XP32-SP11-02	182.5	60	268	35.5	1600				
504692	ZD05-36.0-XP32-SP11-02	185	60	271	36	1600				
504694	ZD05-36.5-XP32-SP11-02	187.5	60	273	36.5	1600				
504696	ZD05-37.0-XP32-SP11-02	190	60	276	37	1600				
504698	ZD05-37.5-XP32-SP11-02	192.5	60	278	37.5	1600				
504700	ZD05-38.0-XP32-SP11-02	195	60	281	38	1600				
504702	ZD05-38.5-XP32-SP11-02	197.5	60	283	38.5	1600				
504704	ZD05-39.0-XP32-SP11-02	200	60	284	39	1600				
504706	ZD05-39.5-XP32-SP11-02	202.5	60	288	39.5	1600				
504708	ZD05-40.0-XP32-SP11-02	205	60	291	40	1900				
504710	ZD05-41.0-XP32-SP14-02	210	60	296	41	1900				
504712	ZD05-42.0-XP32-SP14-02	215	60	301	42	1900				
504714	ZD05-43.0-XP40-SP14-02	220	65	315	43	1900				
504716	ZD05-44.0-XP40-SP14-02	225	65	320	44	1900				
504718	ZD05-45.0-XP40-SP14-02	230	65	325	45	1900				
504720	ZD05-46.0-XP40-SP14-02	235	65	330	46	2100				
504722	ZD05-47.0-XP40-SP14-02	240	65	335	47	2100				
504724	ZD05-48.0-XP40-SP07-04	245	65	340	48	2100				
504726	ZD05-49.0-XP40-SP07-04	250	65	345	49	2100				
504728	ZD05-50.0-XP40-SP07-04	255	65	350	50	2100				
504730	ZD05-51.0-XP40-SP07-04	260	65	355	51	2300				
504732	ZD05-52.0-XP40-SP09-04	265	65	360	52	2300				
504734	ZD05-53.0-XP40-SP09-04	270	65	365	53	2300				
504736	ZD05-54.0-XP40-SP09-04	275	65	370	54	2300				
504738	ZD05-55.0-XP40-SP09-04	280	65	375	55	2300				
504740	ZD05-56.0-XP40-SP09-04	285	65	380	56	2600				
504742	ZD05									

硬质合金铲钻刀杆

3D直槽侧固柄 3D langed Shank



Order	型号 Model	L	L1	L2	D	D1	螺丝 screw	材料 end	Price
500100	SDT03-11.0-11.9-H-XP20	112	36	48	11.0-11.9	20	M1.8*4.5	T6	
500102	SDT03-12.0-12.9-H-XP20	116	39	48	12.0-12.9	20	M2*5	T6	
500104	SDT03-13.0-13.9-H-XP20	118	42	48	13.0-13.9	20	M2*5	T6	
500106	SDT03-14.0-14.9-H-XP20	122	45	48	14.0-14.9	20	M2*5	T6	
500108	SDT03-15.0-15.9-H-XP20	126	48	48	15.0-15.9	20	M2*5	T6	
500110	SDT03-16.0-16.9-H-XP20	130	51	48	16.0-16.9	20	M2.5*6	T8	
500112	SDT03-17.0-17.9-H-XP20	134	54	48	17.0-17.9	20	M2.5*7	T8	
500114	SDT03-18.0-19.9-H-XP25	150	57	56	18.0-19.9	25	M3*7.5	T10	
500116	SDT03-20.0-21.9-H-XP25	156	66	56	20.0-21.9	25	M3*7.5	T10	
500118	SDT03-22.0-23.9-H-XP25	162	72	56	22.0-23.9	25	M3*9	T10	
500120	SDT03-24.0-25.9-H-XP25	168	78	56	24.0-25.9	25	M3*9	T10	
500122	SDT03-26.0-28.9-H-XP32	186	87	60	26.0-28.9	32	M4*10	T15	
500124	SDT03-29.0-31.9-H-XP32	195	96	60	29.0-31.9	32	M4*10	T15	
500126	SDT03-32.0-35.0-H-XP32	205	105	60	32.0-35.0	32	M4*10	T15	

5D直槽侧固柄 5D langed Shank tight flute Order



Order	型号 Model	L	L1	L2	D	D1	螺丝 screw	材料 end	Price
500200	SDT05-11.0-11.9-H-XP20	136	60	48	11.0-11.9	20	M1.8*4.5	T6	
500202	SDT05-12.0-12.9-H-XP20	142	65	48	12.0-12.9	20	M2*5	T6	
500204	SDT05-13.0-13.9-H-XP20	146	70	48	13.0-13.9	20	M2*5	T6	
500206	SDT05-14.0-14.9-H-XP20	152	75	48	14.0-14.9	20	M2*5	T6	
500208	SDT05-15.0-15.9-H-XP20	158	80	48	15.0-15.9	20	M2*5	T6	
500210	SDT05-16.0-16.9-H-XP20	164	85	48	16.0-16.9	20	M2.5*6	T8	
500212	SDT05-17.0-17.9-H-XP20	170	90	48	17.0-17.9	20	M2.5*7	T8	
500214	SDT05-19.0-19.9-H-XP25	190	100	56	18.0-19.9	25	M3*7.5	T10	
500216	SDT05-20.0-21.9-H-XP25	200	110	56	20.0-21.9	25	M3*7.5	T10	
500218	SDT05-22.0-23.9-H-XP25	210	120	56	22.0-23.9	25	M3*9	T10	
500220	SDT05-24.0-25.9-H-XP25	220	130	56	24.0-25.9	25	M3*9	T10	
500222	SDT05-26.0-28.9-H-XP32	245	145	60	26.0-28.9	32	M4*10	T15	
500224	SDT05-29.0-31.9-H-XP32	259	160	60	29.0-31.9	32	M4*10	T15	
500226	SDT05-32.0-35.0-H-XP32	275	175	60	32.0-35.0	32	M4*10	T15	

7D直槽侧固柄 7D langed Shank tight flute Order



Order	型号 Model	L	L1	L2	D	D1	螺丝 screw	材料 end	Price
500300	SDT07-11.0-11.9-H-XP20	160	84	48	11.0-11.9	20	M1.8*4.5	T6	
500302	SDT07-12.0-12.9-H-XP20	168	91	48	12.0-12.9	20	M2*5	T6	
500304	SDT07-13.0-13.9-H-XP20	174	98	48	13.0-13.9	20	M2*5	T6	
500306	SDT07-14.0-14.9-H-XP20	182	105	48	14.0-14.9	20	M2*5	T6	
500308	SDT07-15.0-15.9-H-XP20	190	112	48	15.0-15.9	20	M2*5	T6	
500310	SDT07-16.0-16.9-H-XP20	198	119	48	16.0-16.9	20	M2.5*6	T8	
500312	SDT07-17.0-17.9-H-XP20	206	126	48	17.0-17.9	20	M2.5*7	T8	
500314	SDT07-18.0-19.9-H-XP25	230	140	56	18.0-19.9	25	M3*7.5	T10	
500316	SDT07-20.0-21.9-H-XP25	244	154	56	20.0-21.9	25	M3*7.5	T10	
500318	SDT07-22.0-23.9-H-XP25	258	168	56	22.0-23.9	25	M3*9	T10	
500320	SDT07-24.0-25.9-H-XP25	272	182	56	24.0-25.9	25	M3*9	T10	
500322	SDT07-26.0-28.9-H-XP32	303	203	60	26.0-28.9	32	M4*10	T15	
500324	SDT07-29.0-31.9-H-XP32	323	224	60	29.0-31.9	32	M4*10	T15	
500326	SDT07-32.0-35.0-H-XP32	345	245	60	32.0-35.0	32	M4*10	T15	

铲钻使用小提示

- 一、铲钻是传统麻花钻的升级换代产品，可应用于数控设备及各种传统设备上，如立钻、摇臂钻等。
- 二、铲钻刀片分为硬质合金和高速钢两种材料，所安装的刀杆也是不同的，不能互换。
- 三、立钻、摇臂钻上推荐使用高速钢刀片。但不建议使用硬质合金刀片。机床转速低，刚性差，间隙大，易造成硬质合金刀片崩刃。
- 四、所有铲钻刀杆均有中心出水孔，推荐尽量使用高压高流量内冷却液，这样会大大地延长刀片的使用寿命，更加有利于排屑。
- 五、所有刀片均为断屑槽设计，出来的铁屑均为小碎屑。
- 六、铲钻刀片具有自定心功能，双刃对称均受力，所以适合打深孔。长径比在5倍以内的，先选用浅孔钻（U钻），刀具成本比较省，超5倍径的建议使用铲钻。
- 七、在冷却液压力够高，流量够大，排屑顺畅情况下，铲钻可以一打到底，不需要回退排屑。

Tips: shig topade drill

- 1.spade drill, upgraded replacement product of traditional twist drill, are applied to CNC and variety of conventional equipment, such as vertical drill, radial drill etc.
- 2.The material of spade drill inserts include cobalt and HSS, which are mounted no different other than as on a bit be changed.
- 3.Recommendation for SPS inserts of vertical drill and radial drill, carbide inserts are likely to cause chip clogging due to low speed, rigidity and large gap.
- 4.All spade drill holders are center water hole. It is recommended to use high pressure and high flow coolant which will greatly extend insert life and accelerate chip evacuation.
- 5.All inserts are designed of chip breaker and use of both will be more effective.
- 6.spade drill inserts are self-centering, double symmetric uniform stress are stable of deep hole drilling. When length of diameter ratio is in 5 we suggest preferred shallow hole drill (U drill) or facing drill. More than 5 we recommend spade drill.
- 7.under enough coolant pressure and flow and smooth chip evacuation, spade drill are used of one hit drilling.

高速钢铲钻刀杆

3D莫氏柄铲钻规格 3D Morse Shank spade drill



Order	型号 Model	L	L1	L2	D	D1	螺丝 screw	材料 end	Price
501100	SDS03-09.5-11.0-MT2	181	36	80	9.5-11.0	MT2	M2*5	T6	7281
501102	SDS03-11.1-12.9-MT2	187	42	80	11.1-12.9	MT2	M2*5	T6	7281
501104	SDS03-13.0-15.0-MT2	193	48	80	13.0-15.0	MT2	M2.5*6	T8	7281
501106	SDS03-15.1-17.5-MT2	200	55	80	15.1-17.5	MT2	M2.5*6	T8	7500
501108	SDS03-17.6-19.5-MT3	226	61	99	17.6-19.5	MT3	M3*8	T10	8250
501110	SDS03-19.6-21.5-MT3	232	67	99	19.6-21.5	MT3	M3*8	T10	8250
501112	SDS03-21.6-24.4-MT3	241	76	99	21.6-24.4	MT3	M3*8	T10	8250
501114	SDS03-24.5-26.5-MT4	284	82	124	24.5-26.5	MT4	M3.5*10	T15	9156
501116	SDS03-26.6-28.5-MT4	290	88	124	26.6-28.5	MT4	M3.5*10	T15	9156
501118	SDS03-28.6-30.5-MT4	296	94	124	28.6-30.5	MT4	M3.5*10	T15	9500
501120	SDS03-30.6-32.5-MT4	302	100	124	30.6-32.5	MT4	M3.5*10	T15	9500
501122	SDS03-32.6-34.9-MT4	309	107	124	32.6-34.9	MT4	M3.5*10	T15	9500
501124	SDS03-35.0-37.9-MT5	360	111	156	35.0-37.9	MT5	M3.5*10	T15	10594
501126	SDS03-38.0-40.9-MT5	369	125	156	38.0-40.9	MT5	M3.5*10	T15	10594
501128	SDS03-41.0-43.9-MT5	378	134	156	41.0-43.9	MT5	M3.5*10	T15	11000
501130	SDS03-44.0-47.9-MT5	390	146	156	44.0-47.9	MT5	M3.5*10	T15	11469
501132	SDS03-48.0-51.9-MT5	402	158	156	48.0-51.9	MT5	M5*15	T20	12031
501134	SDS03-52.0-55.9-MT5	414	170	156	52.0-55.9	MT5	M5*15	T20	12656
501136	SDS03-56.0-59.9-MT5	426	182	156	56.0-59.9	MT5	M 35	T20	13281
501138	SDS03-60.0-65.0-MT5	442	198	156	60.0-65.0	M 5	M 35	T20	13875

5D莫氏柄铲钻规格 5D Morse Shank spade drill



Order	型号 Model	L	L1	L2	D	D1	螺丝 screw	材料 end	Price
501200	SDS05-09.5-11.0-MT2	203	58	80	9.5-11.0	MT2	M2*5	T6	8063
501202	SDS05-11.1-12.9-MT2	213	68	80	11.1-12.9	MT2	M2*5	T6	8063
501204	SDS05-13.0-15.0-MT2	223	78	80	13.0-15.0	MT2	M2.5*6	T8	8063
501206	SDS05-15.1-17.5-MT2	235	90	80	15.1-17.5	MT2	M2.5*6	T8	8313
501208	SDS05-17.6-19.5-MT3	265	100	99	17.6-19.5	MT3	M3*8	T10	9094
501210	SDS05-19.6-21.5-MT3	275	110	99	19.6-21.5	MT3	M3*8	T10	9094
501212	SDS05-21.6-24.4-MT3	290	125	99	21.6-24.4	MT3	M3*8	T10	9094
501214	SDS05-24.5-26.5-MT4	337	135	124	24.5-26.5	MT4	M3.5*10	T15	10031
501216	SDS05-26.6-28.5-MT4	347	145	124	26.6-28.5	MT4	M3.5*10	T15	10031
501218	SDS05-28.6-30.5-MT4	357	155	124	28.6-30.5	MT4	M3.5*10	T15	10438
501220	SDS05-30.6-32.5-MT4	367	165	124	30.6-32.5	MT4	M3.5*10	T15	10438
501222	SDS05-32.6-34.9-MT4	380	178	124	32.6-34.9	MT4	M3.5*10	T15	10438
501224	SDS05-35.0-37.9-MT5	436	192	156	35.0-37.9	MT5	M3.5*10	T15	11594
501226	SDS05-38.0-40.9-MT5	452	208	156	38.0-40.9	MT5	M3.5*10	T15	11594
501228	SDS05-41.0-43.9-MT5	566	222	156	41.0-43.9	MT5	M3.5*10	T15	12063
501230	SDS05-44.0-47.9-MT5	486	242	156	44.0-47.9	MT5	M3.5*10	T15	12625
501232	SDS05-48.0-51.9-MT5	506	262	156	48.0-51.9	MT5	M5*15	T20	13281
501234	SDS05-52.0-55.9-MT5	526	282	156	52.0-55.9	MT5	M5*15	T20	13969
501236	SDS05-56.0-59.9-MT5	546	302	156	56.0-59.9	MT5	M5*15	T20	14688
501238	SDS05 60.0-65.0 MT5	572	328	156	60.0-65.0	MT5	M5*15	T20	15406

7D莫氏柄铲钻规格 7D Morse Shank spade drill



Order	型号 Model	L	L1	L2	D	D1	螺丝 screw	材料 end	Price
501300	SDS07-09.5-11.0-MT2	225	80	80	9.5-11.0	MT2	M2*5	T6	9625
501302	SDS07-11.1-12.9-MT2	238	93	80	11.1-12.9	MT2	M2*5	T6	9625
501304	SDS07-13.0-15.0-MT2	253	108	80	13.0-15.0	MT2	M2.5*6	T8	9625
501306	SDS07-15.1-17.5-MT2	270	125	80	15.1-17.5	MT2	M2.5*6	T8	9906
501308	SDS07-17.6-19.5-MT3	304	139	99	17.6-19.5	MT3	M3*8	T10	10750
501310	SDS07-19.6-21.5-MT3	318	153	99	19.6-21.5	MT3	M3*8	T10	10750
501312	SDS07-21.6-24.4-MT3	338	173	99	21.6-24.4	MT3	M3*8	T10	10750
501314	SDS07-24.5-26.5-MT4	390	188	124	24.5-26.5	MT4	M3.5*10	T15	11750
501316	SDS07-26.6-28.5-MT4	404	202	124	26.6-28.5	MT4	M3.5*10	T15	11750
501318	SDS07-28.6-30.5-MT4	418	216	124	28.6-30.5	MT4	M3.5*10	T15	12281
501320	SDS07-30.6-32.5-MT4	432	230	124	30.6-32.5	MT4	M3.5*10	T15	12281
501322	SDS07-32.6-34.9-MT4	449	247	124	32.6-34.9	MT4	M3.5*10	T15	12281
501324	SDS07-35.0-37.9-MT5	512	268	156	35.0-37.9	MT5	M3.5*10	T15	13500
501326	SDS07-38.0-40.9-MT5	533	289</						

多功能钻杆

多功能系列产品
车削、镗削、钻削功能，
用硬种刀具加工，
节约安装时间，缩短节拍，
减少刀具使用效果，节约
刀具成本。

应用
· 传统方式



特点

- 内冷型
- 大螺旋槽利于排屑
- 大排屑槽提高排屑
- 刀片两张切刃设计适于钻削和车削
- 大螺旋角切刃降低切削力
- 小进给、小切深时排屑流畅



Order	型号 Model	D	d	L1	L	适用刀片 Applicable Insert	螺丝 Screw	扳手 Wrench	Price
505100	TCAP-09R.L-3.0DN	8	12	24	75	XCMT 40 10 40	M1.8 x 35	T6	1875
505102	TCAP-09R.L-3.0DN	9	12	27	83	XCMT 50 20 40	M2 x 5	T6	1875
505104	TCAP-10R.L-3.0DN	10	12	30	85	XCMT 50 20 40	M2 x 5	T6	1875
505106	TCAP-11R.L-3.0DN	11	16	33	92	XCMT 60 20 40	M2.2 x 5	T6	1875
505108	TCAP-12R.L-3.0DN	12	16	36	95	XCMT 60 20 40	M2.2 x 5	T6	1875
505110	TCAP-13R.L-3.0DN	13	16	39	100	XCMT 70 30 40	M2.5 x 65	T8	1875
505112	TCAP-14R.L-3.0DN	14	16	42	101	XCMT 70 30 40	M2.5 x 65	T8	1875
505114	TCAP-09R.L-2.25DN	8	12	18	69	XCMT 40 10 40	M1.8 x 35	T6	1875
505116	TCAP-09R.L-2.25DN	9	12	20.5	76	XCMT 50 20 40	M2 x 5	T6	1875
505118	TCAP-10R.L-2.25DN	10	12	22.5	78	XCMT 50 20 40	M2 x 5	T6	1875
505120	TCAP-11R.L-2.25DN	11	16	25	84	XCMT 60 20 40	M2.2 x 5	T6	1875
505122	TCAP-12R.L-2.25DN	12	16	27	86	XCMT 60 20 40	M2.2 x 5	T6	1875
505124	TCAP-13R.L-2.25DN	13	16	29.5	91	XCMT 70 30 40	M2.5 x 65	T8	1875
505126	TCAP-14R.L-2.25DN	14	16	31.5	91	XCMT 70 30 40	M2.5 x 65	T8	1875

变径套

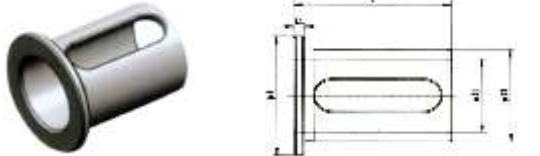

Order	型号	尺寸 (mm)					Price
		D	D1	D2	L	L1	
505200	BJT-322062	20	49	32	62	5	500
505202	BJT-322562	25	49	32	62	5	500
505204	BJT-402065	20	58	40	65	6	625
505206	BJT-402565	25	58	40	65	6	625
505208	BJT-403265	32	58	40	65	6	625
505210	BJT-502572	25	65	50	70	6	750
505212	BJT-503272	32	65	50	70	6	750
505214	BJT-504072	40	65	50	70	6	750

偏心套



Order	型号	尺寸 (mm)							加工直径 调整范围内	中心高 调整范围	Price
		D1	D2	D	L	L1	L2	L3			
505300	2025-43	20	25	41	47	6	11	33	+0.4-0.2	+0.2-0.15	1250
505302	2532-48	25	32	49	60	6	11	45	+0.4-0.2	+0.2-0.15	1250
505304	3240-53	32	40	58	65	6	11	50	+0.4-0.2	+0.2-0.15	1563
505306	4050-63	40	50	68	76	6	11	61	+0.6-0.2	+0.2-0.2	1750

固定座



溢刀柄

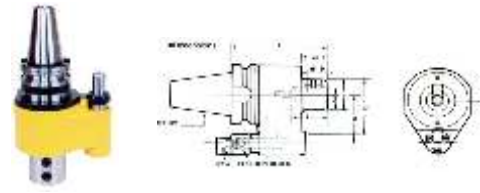

Order	型号	d	L	B	c	D	LO	L1	H	L3	Price
505400	BT40-OSL32-155	32	155	60/65	53	90	50	60	15	15	
505402	BT40-OSL40-155	40	155	60/65	70	90	50	70	19	18	
505404	BT50-OSL32-160	32	160	80/82	54	100	50	60	15	15	
505406	BT50-OSL40-160	40	160	80/82	64	100	50	70	19	18	



莫氏转换柄



Order	型号	D	D1	L	L1	Price
505500	D N228-B-32-MTA4	32	64	204	124	1438
505502	D N228-B-40-MTA4	40	64	204	124	1438
505504	D N228-B-32-MTA5	32	64	204	156	1563
505506	D N228-B-40-MTA5	40	64	204	156	1563
505508	D N228-B-32-MTA6	32	64	303	218	1875
505510	D N228-B-40-MTA6	40	64	303	218	1875
505512	D N228-B-50-MTA6	50	74	303	218	2188

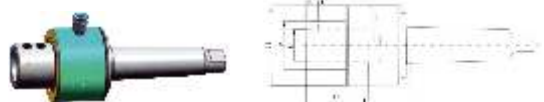

Order	型号	D	D1	D2	L	L1	L2	L3	Price
505600	MT5-YLDB-32	32	55	92	127	15	18	60	5000
505602	MT5-YLDB-40	40	60	98	127	15	18	65	5313
505604	MT6-YLDB-32	32	55	92	127	15	18	60	5625
505606	MT6-YLDB-40	40	60	98	127	15	18	65	5625
505608	MT6-YLDB-50	50	70	108	127	15	18	70	5938

刀具成功案例

实物 Product	技术要求 Drawings	说明 Instruction
		摆、倒角、沉孔三个工序集中在一把刀上面，一气呵成。 Three process boring, chamfer, counter bore, concentric line out.
		打眼后通过小刀夹精镗，确保尺寸精度。 After boring through temp finishing using a small diameter tool to ensure dimensional accuracy.
		优化刀片角度，使之能打叠板，随后小刀夹精镗尺寸。 Optimizing insert angle to lay over lay board, then temp finishing using extension.
		打眼、倒角、镗平面高效、快捷，莫氏连接柄，可在立钻、普车尾架等工作。 Efficient and convenient boring chamfer spot facing. With Morse handle and work on vertical mill lathe, etc.
		风力发电轴承孔专用钻杆，特殊排屑槽，对称双刃刀，针对性优化设计，42CrMo，HB280，SI000，F200，低转速，高进给，低磨损，高效率。 Wind power bearing hole special drill rod, special chip breaker, symmetrical double flute angled and optimized design 42CrMo, HB280 SI000 F200, low speed, high feed, low wear, high efficiency.
		游艇玻璃钢打眼专用，特殊材质，双吹气设计，产品尺寸稳定不变形。 Dedicated boring of light RP special material designed in double low product dimension for stability no deformation.
		组合式结构，配合普通麻花钻，角决小孔的复合刀问题。 Modular structure match with ordinary twist drill to solve the compound drill keyhole.

备注：所有所列复合刀具，均实际生产使用过。

快速
钻孔

镗孔
加工
系统

钻头

铰刀

快速
钻头

高精度
铰钻

VMD
大钻头

U钻
配件

BH
镗孔

RBH
粗镗

CBH
精镗

CBR
外圆
精镗

WBST
镗孔

CBI
小径
精镗

精镗
套装

镗孔
配件

BS
粗镗

高速钢
钻头

钨钢
钻头

铰刀

舍弃式钻头 | Abandon Type Drill

小夹



Order	型号	内刀	外刀	刀片	刀数	螺丝	扳手	Price
506100	45-50	VNC-045050N	VMC-045050T	WC..030204	2	TSB-22045	T6	1125
506102	50-55	VNC-050055N	VMC-050055T	WC..030204	2	TSB-25055		1125
506104	55-60	VNC-055060N	VMC-055060T	WC..040204	2	TSB-25055		1125
506106	60-65	VNC-060065N	VMC-060065T					1250
506108	65-70	VNC-065070N	VMC-065070T	WC..050308	2	TSB-30070	T10	1250
506110	70-75	VNC-070075N	VMC-070075T					1250
506112	75-80	VNC-075080N	VMC-075080T					1563
506114	80-85	VNC-080085N	VMC-080085T					1563
506116	85-90	VNC-085090N	VMC-085090T	WC..06T308	2	TSB-35090	T15	1563
506118	90-95	VNC-090095N	VMC-090095T					1563
506120	95-100	VNC-095100N	VMC-095100T					1875
506122	100-105	VNC-100105N	VMC-100105T	WC..050308	3	TSB-30070	T10	1875
506124	105-110	VNC-105110N	VMC-105110T					1875
506126	110-115	VNC-110115N	VMC-110115T					1875
506128	115-120	VNC-115120N	VMC-115120T					1875
506130	120-125	VNC-120125N	VMC-120125T	WC..06T308	3	TSB-35090		1875
506132	125-130	VNC-125130N	VMC-125130T					1875
506134	130-135	VNC-130135N	VMC-130135T					1875
506136	135-140	VNC-135140N	VMC-135140T					2500
506138	140-150	VNC-140150N	VMC-140150T					2500
506140	150-160	VNC-150160N	VMC-150160T					2500
506142	160-170	VNC-160170N	VMC-160170T	WC..080408	3	TSB-40110		3125
506144	170-180	VNC-170180N	VMC-170180T					3125

MD大钻头



Order	型号	D	Ds	D1	导向孔D2	L1	L	刀夹	适用刀片	螺丝	扳手	Price
506200	VMD-045050	45	16	30	PLS-1038	60	95	VMC-045050N/T	WCM T030208	TSB-25055	T8	7875
506202	VMD-050055	55	25	45	TN-H			VMC-050055N/T	WCM T040208			7875
506204	VMD-055060	60	30	50	PLS-1238			VMC-060065N/T	WCM T050308	TSB-30070		7875
506206	VMD-060065	65	32	58	TN-H			VMC-065070N/T				8438
506208	VMD-065070	70	40	70				VMC-070075N/T				9338
506210	VMD-070075	75	50	80				VMC-075080N/T				9500
506212	VMD-075080	80	50	80	PLS-1645	82		VMC-080085N/T	WCM T06T308	TSB-35090	T15	10063
506214	VMD-080085	85	50	80	TN-H			VMC-085090N/T				10625
506216	VMD-085090	90	50	80				VMC-090095N/T				11313
506218	VMD-090095	95	50	80				VMC-095100N/T	WCM T050308	TSB-30070	T8	11938
506220	VMD-095100	100	50	80				VMC-100105N/T				12625
506222	VMD-100105	105	50	80	PLS-2045	94		VMC-105110N/T	WCM T06T308	TSB-30070	T8	13625
506224	VMD-105110	110	50	80	TN-H			VMC-110115N/T				14438
506226	VMD-110115	115	50	80				VMC-115120N/T				15813
506228	VMD-115120	120	50	80				VMC-120125N/T	WCM T06T308	TSB-35090		16438
506230	VMD-120125	125	50	80				VMC-125130N/T				17875
506232	VMD-130135	135	50	80				VMC-130135N/T				18688
506234	VMD-135140	140	50	80				VMC-135140N/T				19688
506236	VMD-140145	145	50	80				VMC-140145N/T				21188
506238	VMD-145150	150	50	80	PLS-2556	116	176	VMC-145150N/T				21968
506240	VMD-150155	155	50	80	TN-H			VMC-150155N/T				22750
506242	VMD-155160	160	50	80				VMC-155160N/T				23531
506244	VMD-160165	165	50	80				VMC-160165N/T				24898
506246	VMD-165170	170	50	80				VMC-165170N/T	WCM T080408	TSB-40110		25625
506248	VMD-170175	175	50	80				VMC-170175N/T				26563
506250	VMD-175180	180	50	80				VMC-175180N/T				28125

接杆

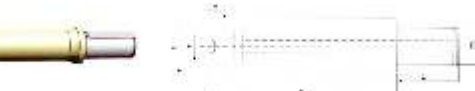

Order	型号	D	D1	D2	L	L1	M	适用范围	Price
506300	DX2-3016100	30	16	32	100	75	M10X1	45-50	2188
506302	DX2-3013150	30	16	32	150	75	M10X1		2188
506304	DX2-3016200	30	16	32	200	75	M10X1		2500
506306	DX2-3016250	30	16	32	250	75	M10X1		2800
506308	DX2-3016300	30	16	32	300	75	M10X1		3100
506310	DX2-3016400	30	16	32	400	75	M10X1		3400
506312	DX2-4525100	45	25	40	100	75	M10X1	60-80	2500
506314	DX2-4525150	45	25	40	150	75	M10X1		2500
506316	DX2-4525200	45	25	40	200	75	M10X1		2813
506318	DX2-4525250	45	25	40	250	75	M10X1		3125
506320	DX2-4525300	45	25	40	300	75	M10X1		3438
506322	DX2-4525400	45	25	40	400	75	M10X1		3750
506324	DX2-5030100	50	30	40	100	75	M12X1	85-90	3125
506326	DX2-5030150	50	30	40	150	75	M12X1		3438
506328	DX2-5030200	50	30	40	200	75	M12X1		3750
506330	DX2-5030250	50	30	40	250	75	M12X1		3750
506332	DX2-5030300	50	30	40	300	75	M12X1		3750
506334	DX2-5030400	50	30	40	400	75	M12X1		4375
506336	DX2-5832100	58	32	40	100	75	M12X1		3750
506338	DX2-5832150	58	32	40	150	75	M12X1		3750
506340	DX2-5832200	58	32	40	200	75	M12X1		4063
506342	DX2-5832250	58	32	40	250	75	M12X1		4375
506344	DX2-5832300	58	32	40	300	75	M12X1		4600
506346	DX2-5832400	58	32	40	400	75	M12X1		4900
506348	DX2-7040100	70	40	50	100	80	M12X1	110-115	5000
506350	DX2-7040150	70	40	50	150	80	M12X1		5000
506352	DX2-7040200	70	40	50	200	80	M12X1		5625
506354	DX2-7040250	70	40	50	250	80	M12X1		5625
506356	DX2-7040300	70	40	50	300	80	M12X1		6250
506358	DX2-7040400	70	40	50	400	80	M12X1		7500
506360	DX2-8050100	80	50	50	100	80	M12X1		6250
506362	DX2-8050150	80	50	50	150	80	M12X1		6250
506364	DX2-8050200	80	50	50	200	80	M12X1		6750
506366	DX2-8050250	80	50	50	250	80	M12X1		7500
506368	DX2-8050300	80	50	50	300	80	M12X1		8125
506370	DX2-8050400	80	50	50	400	80	M12X1		9375

定钻

Order	型号	D	L	Price
506400	PLD-V1035 N-H	10	35	769
506402	PLD-V1238 N-H	12	38	988
506404	PLD-V1645 N-H	16	45	1125
506406	PLD-2045 N-H	20	45	1625
506408	PLD-2556 N-H	25	56	2100
506410	PLD-3068 N-H	30	68	2800

MD可转位大钻头大幅提高加工效率

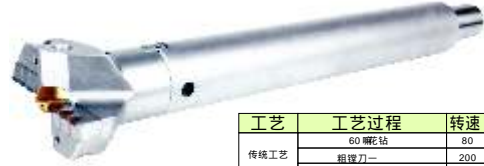

工艺	工艺过程	转速	进给	加工时间	总用时
传统工艺	60°麻花钻	80	16	1小时10分钟	150分钟
	插齿刀	200	30	40分钟	
新工艺	插齿刀	200	30	40分钟	18分钟
	VMD可转位大钻头	105	20	45分钟	

钻头转速

$$S = \frac{V_c \times 1000}{\pi \times D \times 60}$$

V_c = 切削速度 0.0m/min
 D = 钻头直径
 S = 进给速度

实例: 以钻头直径 100 为例,
 $S = \frac{100 \times 1000}{\pi \times 100 \times 60} = 318 \text{ rev/min}$

进给速度

$$V = F \times r \times s$$

V = 进给速度
 F = 每转进给量
 S = 进给速度

实例: 以钻头直径 100 为例, 每转进给量 1.5 mm/rev, 0.0
 $V = 0.15 \times \pi \times 318 = 47.7 \text{ mm/min}$

孔加工时间

$$T_c = \frac{H}{V} \times 60$$

T_c = 加工时间
 H = 待加工深度

实例: 以钻头直径 100 为例, 孔加工深度 0.0mm, 为 1
 $T_c = \frac{100 \times 60}{47.7} = 126 \text{ (s)}$

在石油、煤矿等机械行业中,大孔加工越来越普遍,应用VMD可转位大钻头可大幅提高加工效率,VMD可转位大钻头的亮点:

- 一、采用中心导向钻结构,有较好的定心效果,从而保证孔位有良好的直线度。
- 二、内外刀刃采用可替换小刀夹结构,在实际使用中,最易损坏的是外刀刃夹通过替换小刀夹,避免了整支钻头的报废,节省了刀具成本。
- 三、通过调整外刀夹,钻头加工尺寸可以在0-5mm 变动。
- 四、刀头和刀柄采用组合式结构,加工不同孔的深度,只需更换不同长度的刀柄即可。
- 五、钻头有中心出水孔,可以较好的冷却刀片,延长刀片的使用寿命,同时有利于排屑。
- 六、采用可转位硬质合金刀片切削,有较高的转速和进给,孔壁光洁度有大幅提升。
- 七、加工过程中,铁屑均为断屑状态,没有传统麻花钻的细长缠绕的铁屑,安全性大大提高。
- 八、加工中,自动连续进刀,不需要每次退回回屑,效率大幅提升。

Machining 0.5m depth 50mm material 20CrMoHB220
 In the industrial and other industries, large hole machining becomes one of the most common applications. VMD indexable drill bits can greatly improve the machining efficiency. The right part VMD indexable drill bit structure force center guide drill bit better centering effect to take use of its good straightness.

1. Adopt the center guide structure, which has a good centering effect, ensuring the hole has good straightness.
2. Internal and external cutting edges are replaced by the structure of replaceable lamina. In practical use, the most vulnerable external cutting edge is replaced by a lamina of the same length to avoid the replacement of the whole drill bit.
3. Adjust the external lamina, the dimension for hole machining can vary within ±0.5mm.
4. The head and handle are modular structure. Only change different length handle using processing hole of different depth for hole.
5. The center water hole can be adjusted to extend the life of the cutting edge and reduce the chip.
6. The indexable cutting edge is used with high speed and feed, so the surface finish is greatly improved.
7. The chip is broken, so the chip breaker is not needed on the outer diameter of the drill bit.
8. The process is automatic continuous feed and does not need to be retracted to clear chips, and efficiency is greatly improved.

嗽钻系列



1. 双套管压泵从孔壁和套管之间供油
 1 Coolant is fed through the hole between the hole pressure and the outside of the drill tube and the oil well.
2. 钻头和套管之间用密封圈密封
 2 A seal is between the workpiece and the drill tube is necessary.
3. 嗽钻(双套管BTA)的两倍冷却液压力和流量
 3 Double the coolant pressure and quantity is required than the traditional system.
4. 适合切削材料加工,如不锈钢、低碳钢和组织不均匀的材质等
 4 Preferably used for materials with high chip formation, such as stainless steel, low carbon steel and materials with uneven structure.
5. 加工超深孔和超大孔上,单孔钻系统更具优势
 5 Single hole system is more advantageous on extremely long workpieces and of work